

VCR金属面密封接头

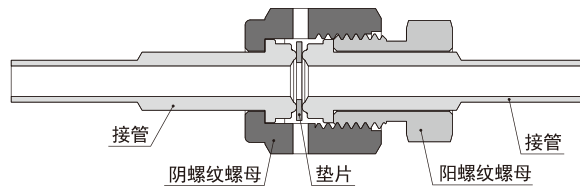

- 全金属密封，可实现无泄漏
- 精密制造的垫片确保最佳密封效果
- 螺母端测试孔易于进行泄漏测试
- 螺母内螺纹镀银
- 标准平均表面粗糙度Ra 0.25 μm或电解抛光Ra 0.13 μm
- 尺寸范围：1/16"至1"和6 mm至18 mm

标准结构



型号和尺寸

短自动焊对焊接管

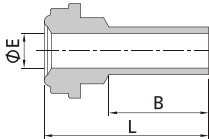

基本型号	端口形式和尺寸			尺寸, mm		
	VCR接口	TUe 管对焊		L	B	E
	管外径	管外径	壁厚			
SS-U-2/2-VCR/TB	1/8 in.	1/8 in.	0.028 in.	27.4	19.1	1.5
SS-U-4/2-VCR/TB	1/4 in.	1/8 in.	0.028 in.	27.9	19.1	1.5
SS-U-4/4-VCR/TB-4	1/4 in.	1/4 in.	0.035 in.	15.2	6.4	4.6
SS-U-4/4-VCR/TB	1/4 in.	1/4 in.	0.035 in.	27.9	19.1	4.6
SS-U-8/4-VCR/TB	1/2 in.	1/4 in.	0.035 in.	28.4	19.1	4.6
SS-U-8/6-VCR/TB-4	1/2 in.	3/8 in.	0.035 in.	15.7	6.4	7.9
SS-U-8/6-VCR/TB	1/2 in.	3/8 in.	0.035 in.	28.4	19.1	7.9
SS-U-8/8-VCR/TB-4	1/2 in.	1/2 in.	0.049 in.	15.7	6.4	10.2
SS-U-8/8-VCR/TB	1/2 in.	1/2 in.	0.049 in.	28.4	19.1	10.2
SS-U-4/6M-VCR/TB	1/4 in.	6 mm	1 mm	29.5	19.1	4.0
SS-U-4/8M-VCR/TB	1/4 in.	8 mm	1 mm	29.5	19.1	6.0
SS-U-8/10M-VCR/TB	1/2 in.	10 mm	1 mm	29.5	19.1	8.0
SS-U-8/12M-VCR/TB	1/2 in.	12 mm	1 mm	29.5	19.1	10.0
SS-U-12/18M-VCR/TB	3/4 in.	18 mm	1.5 mm	31.0	19.1	15.0

短自动焊对准焊接管

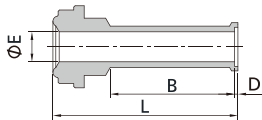

基本型号	端口形式和尺寸			尺寸, mm				
	VCR接口	TUe 管对焊		L	B	D	E	T
	管外径	管外径	壁厚					
SS-U-4/4-VCR/TBA	1/4 in.	1/4 in.	0.035 in.	28.4	19.1	0.5	4.6	7.4
SS-U-8/6-VCR/TBA	1/2 in.	3/8 in.	0.035 in.	29.2	19.1	0.8	7.9	10.4
SS-U-8/8-VCR/TBA	1/2 in.	1/2 in.	0.049 in.	29.5	19.1	1.0	10.2	14.0
SS-U-4/6M-VCR/TBA	1/4 in.	6 mm	1 mm	30.0	19.1	0.5	4.0	6.8
SS-U-4/8M-VCR/TBA	1/4 in.	8 mm	1 mm	30.2	19.1	0.8	6.0	8.9
SS-U-8/10M-VCR/TBA	1/2 in.	10 mm	1 mm	31.0	19.1	0.8	8.0	10.9
SS-U-8/12M-VCR/TBA	1/2 in.	12 mm	1 mm	30.5	19.1	1.0	10.0	13.2

长自动焊对焊接管

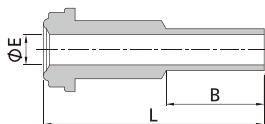

基本型号	端口形式和尺寸			尺寸, mm		
	VCR接口	TUe 管对焊		L	B	E
	管外径	管外径	壁厚			
SS-U-2/2-VCR/TBL	1/8 in.	1/8 in.	0.028 in.	36.1	19.1	1.5
SS-U-4/4-VCR/TBL-4	1/4 in.	1/4 in.	0.035 in.	30.5	6.4	4.6
SS-U-4/4-VCR/TBL	1/4 in.	1/4 in.	0.035 in.	43.2	19.1	4.6
SS-U-8/4-VCR/TBL	1/2 in.	1/4 in.	0.035 in.	45.7	19.1	4.6
SS-U-8/6-VCR/TBL-4	1/2 in.	3/8 in.	0.035 in.	32.8	6.4	7.9
SS-U-8/6-VCR/TBL	1/2 in.	3/8 in.	0.035 in.	45.5	19.1	7.9
SS-U-8/8-VCR/TBL-4	1/2 in.	1/2 in.	0.049 in.	32.8	6.4	10.2
SS-U-8/8-VCR/TBL	1/2 in.	1/2 in.	0.049 in.	45.5	19.1	10.2
SS-U-8/12-VCR/TBL	3/4 in.	3/4 in.	0.049 in.	51.6	19.1	16.5
SS-U-12/16-VCR/TBL	1 in.	1 in.	0.065 in.	58.9	19.1	22.1
SS-U-4/6M-VCR/TBL	1/4 in.	6 mm	1 mm	43.2	19.1	4.0
SS-U-4/8M-VCR/TBL	1/4 in.	8 mm	1 mm	43.2	19.1	6.0
SS-U-8/10M-VCR/TBL	1/2 in.	10 mm	1 mm	45.5	19.1	8.0
SS-U-8/12M-VCR/TBL	1/2 in.	12 mm	1 mm	45.5	19.1	10.0
SS-U-12/18M-VCR/TBL	3/4 in.	18 mm	1.5 mm	51.6	19.1	15.0

长自动焊对准焊接管

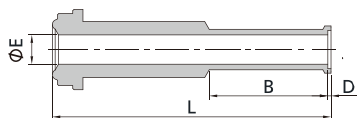

基本型号	端口形式和尺寸			尺寸, mm				
	VCR接口	TUe 管对焊		L	B	D	E	T
	管外径	管外径	壁厚					
SS-U-4/4-VCR/TBLA	1/4 in.	1/4 in.	0.035 in.	43.7	19.1	0.5	4.6	7.4
SS-U-8/4-VCR/TBLA	1/2 in.	1/2 in.	0.035 in.	46.2	19.1	0.5	4.6	7.4
SS-U-8/6-VCR/TBLA	1/2 in.	1/2 in.	0.035 in.	46.2	19.1	0.8	7.9	10.4
SS-U-8/8-VCR/TBLA	1/2 in.	1/2 in.	0.049 in.	46.5	19.1	1	10.2	14
SS-U-12/12-VCR/TBLA	3/4 in.	3/4 in.	0.049 in.	52.6	19.1	1	16.5	20.3
SS-U-4/6M-VCR/TBLA	1/4 in.	6 in.	1 mm	43.7	19.1	0.5	4.0	6.8
SS-U-8/12M-VCR/TBLA	1/2 in.	12 in.	1 mm	46.5	19.1	1.0	10.0	13.2
SS-U-12/12M-VCR/TBLA	3/4 in.	18 in.	1.5 mm	52.6	19.1	1.0	15.0	19.3

长自动焊插焊接管

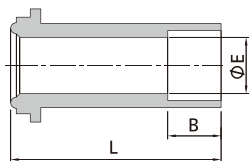

基本型号	端口形式和尺寸		尺寸, mm			
	VCR接口	TUe 管插焊	L	B	E	T
	管外径	管外径				
SS-U-2/1-VCR/TS	1/8in.	1/16in.	17.8	2.5	1.3	3.3
SS-U-2/2-VCR/TS	1/8in.	1/8in.	17.8	2.5	2.3	5.1
SS-U-4/2-VCR/TS	1/4in.	1/8in.	33.3	2.5	2.3	8.9
SS-U-4/4-VCR/TS	1/4in.	1/4in.	33.3	7.1	4.6	8.9
SS-U-8/4-VCR/TS	1/2in.	1/4in.	38.1	7.1	4.6	15.2
SS-U-8/6-VCR/TS	1/2in.	3/8in.	38.1	7.9	7.1	15.2
SS-U-8/8-VCR/TS	1/2in.	1/2in.	38.1	9.7	10.2	15.2
SS-U-10/10-VCR/TS	5/8in.	5/8in.	39.6	10.4	12.7	18.3
SS-U-12/12-VCR/TS	3/4in.	3/4in.	50.8	11.2	15.7	22.4
SS-U-16/16-VCR/TS	1in.	1in.	56.4	15.7	22.1	30.2

变径自动焊插焊接管

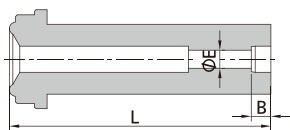

基本型号	端口形式和尺寸		尺寸, mm			
	VCR接口	TUe 管插焊	L	B	E	T
	管外径	管外径				
SS-U-4/2-VCR/TS	1/4 in.	1/8 in.	33.3	2.5	2.3	8.9
SS-U-8/4-VCR/TS	1/2 in.	1/4 in.	38.1	7.1	4.6	15.2

自动焊外焊接管

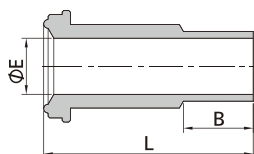

基本型号	端口形式和尺寸		尺寸, mm		
	VCR接口	TUe 管外焊	L	B	E
	管外径	管外径			
SS-U-2/2-VCR/TBS	1/8 in.	1/8 in.	17.8	7.1	1.5
SS-U-4/2-VCR/TBS	1/4 in.	1/8 in.	33.3	7.1	1.5
SS-U-4/4-VCR/TBS	1/4 in.	1/4 in.	33.3	10.4	3.0
SS-U-8/4-VCR/TBS	1/2 in.	1/4 in.	38.1	10.4	3.0
SS-U-8/6-VCR/TBS	1/2 in.	3/8 in.	38.1	10.4	7.1
SS-U-8/8-VCR/TBS	1/2 in.	1/2 in.	38.1	12.7	10.2
SS-U-12/12-VCR/TBS	3/4 in.	3/4 in.	50.8	15.7	13.5
SS-U-16/16-VCR/TBS	1 in.	1 in.	56.4	20.6	19.1

卡套管接管

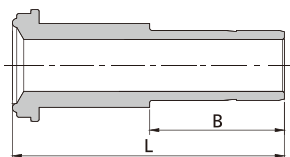

基本型号	端口形式和尺寸		尺寸, mm		
	VCR接口	卡套管外焊	L	B	E
	管外径	管外径			
SS-U-4/4-VCR/TA	1/4 in.	1/4 in.	41.1	16.3	4.3
SS-U-8/6-VCR/TA	1/2 in.	3/8 in.	46.0	17.8	6.9
SS-U-8/8-VCR/TA	1/2 in.	1/2 in.	49.3	24.4	9.4

盲接管

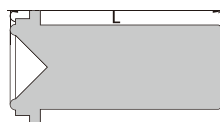

基本型号	端口形式和尺寸		尺寸, mm
	VCR接口	管外径	L
	管外径		
SS-BT-2-VCR	1/8 in.		17.8
SS-BT-4-VCR	1/4 in.		33.3
SS-BT-8-VCR	1/2 in.		38.1
SS-BT-12-VCR	3/4 in.		50.8
SS-BT-16-VCR	1 in.		56.4

MVCR转双卡套穿板本体

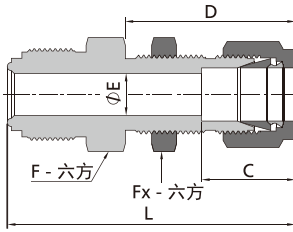

基本型号	端口形式和尺寸		尺寸, mm					
	VCR阳螺纹	双卡套	L	C	D	E	F	FX
SS-B-4/4-MVCR/A	1/4 in.	1/4 in.	57.2	15.2	33.5	4.6	15.9	15.9
SS-B-8/6-MVCR/A	1/2 in.	3/8 in.	64.5	16.8	36.8	7.1	23.8	19.1
SS-B-8/8-MVCR/A	1/2 in.	1/2 in.	69.6	22.9	41.9	10.2	23.8	23.8

MVCR穿板直通本体

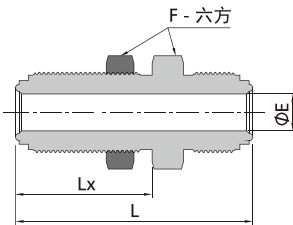

基本型号	端口形式和尺寸		尺寸, mm					面板孔径	最大面板厚度
	VCR阳螺纹		L	LX	E	F			
SS-B-4-MVCR-1.82	1/4 in.		46.2	25.1	4.6	19.1	15	3.3	
SS-B-4-MVCR	1/4 in.		56.6	33.0	4.6	19.1	15	11.2	
SS-B-8-MVCR-2.14	1/2 in.		54.4	28.2	10.2	27	23	3.3	
SS-B-8-MVCR	1/2 in.		65.3	37.6	10.2	27	23	12.7	

MVCR转MNPT穿板本体

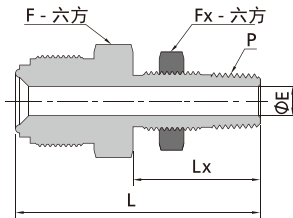

基本型号	端口形式和尺寸		尺寸, mm						
	VCR阳螺纹	NPT阳螺纹	L	LX	E	F	FX	面板孔径	最大面板厚度
SS-B-4/4-MVCR/M	1/4 in.	1/4 in.	56.1	31.5	7.1	20.6	20.6	16.7	9.7
SS-B-8/4-MVCR/M	1/2 in.	1/4 in.	59.4	31.5	7.1	23.8	20.6	16.7	9.7

MVCR转对焊穿板本体

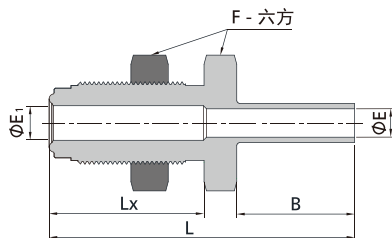

基本型号	端口形式和尺寸		尺寸, mm					
	VCR阳螺纹	TUe管对焊	L	LX	B	E	E1	F
		管外径						
SS-B-4/4-MVCR/TB-1.95	1/4 in.	1/4 in.	49.5	25.1	19.1	4.6	5.6	19.1
SS-B-4/4-MVCR/TB	1/4 in.	1/4 in.	59.9	33.0	19.1	4.6	5.6	19.1

MVCR转FNPT本体

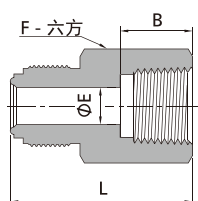

基本型号	端口形式和尺寸		尺寸, mm			
	VCR阳螺纹	NPT阴螺纹	L	B	E	F
SS-U-2/1-MVCR/F	1/8 in.	1/16 in.	27.9	9.9	2.3	11.1
SS-U-2/2-MVCR/F	1/8 in.	1/8 in.	30.2	10.4	2.3	14.3
SS-U-4/2-MVCR/F	1/4 in.	1/8 in.	35.8	10.4	4.6	15.9
SS-U-4/4-MVCR/F	1/4 in.	1/4 in.	39.1	15.0	4.6	19.1
SS-U-8/6-MVCR/F	1/2 in.	3/8 in.	44.7	15.0	10.2	23.8
SS-U-8/8-MVCR/F	1/2 in.	1/2 in.	50.5	19.8	10.2	27.0
SS-U-12/12-MVCR/F	3/4 in.	3/4 in.	59.9	20.6	15.7	33.3
SS-U-16/16-MVCR/F	1 in.	1 in.	63.8	25.4	22.1	41.3

MVCR转双卡套本体

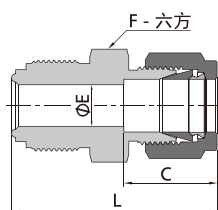

基本型号	端口形式和尺寸		尺寸, mm			
	VCR阳螺纹	双卡套	L	B	E	F
SS-U-4/2-MVCR/A	1/4 in.	1/8 in.	38.9	12.7	2.3	15.9
SS-U-4/4-MVCR/A	1/4 in.	1/4 in.	41.1	15.2	4.6	15.9
SS-U-8/6-MVCR/A	1/2 in.	3/8 in.	46.7	16.8	7.1	23.8
SS-U-8/8-MVCR/A	1/2 in.	1/2 in.	49.5	22.9	10.2	23.8

MVCR转MNPT本体

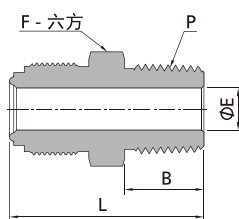

基本型号	端口形式和尺寸		尺寸, mm			
	VCR阳螺纹	NPT阳螺纹	L	B	E	F
SS-U-2/1-MVCR/M	1/8 in.	1/16 in.	27.2	9.7	2.3	9.5
SS-U-2/2-MVCR/M	1/8 in.	1/8 in.	27.2	9.7	2.3	11.1
SS-U-4/2-MVCR/M	1/4 in.	1/8 in.	33.3	9.7	4.6	15.9
SS-U-4/4-MVCR/M	1/4 in.	1/4 in.	37.9	14.2	4.6	15.9
SS-U-8/4-MVCR/M	1/2 in.	1/4 in.	41.9	14.2	7.1	23.8
SS-U-8/6-MVCR/M	1/2 in.	3/8 in.	41.9	19.1	9.7	23.8
SS-U-8/8-MVCR/M	1/2 in.	1/2 in.	46.7	19.1	10.2	23.8
SS-U-12/12-MVCR/M	3/4 in.	3/4 in.	55.6	19.1	15.8	33.3
SS-U-16/16-MVCR/M	1 in.	1 in.	62.7	23.9	22.1	41.3

MVCR直通本体

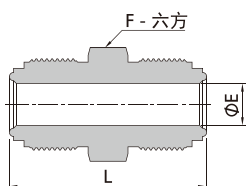

基本型号	端口形式和尺寸		尺寸, mm		
	VCR阳螺纹	VCR阳螺纹	L	E	F
SS-U-2-MVCR	1/8 in.	1/8 in.	28.7	2.3	9.5
SS-U-4/2-MVCR/MVCR	1/4 in.	1/8 in.	34.8	2.3	15.9
SS-U-4-MVCR	1/4 in.	1/4 in.	39.4	4.6	15.9
SS-U-8/4-MVCR/MVCR	1/2 in.	1/4 in.	43.4	4.6	23.8
SS-U-8-MVCR	1/2 in.	1/2 in.	46.7	10.2	23.8
SS-U-12-MVCR	3/4 in.	3/4 in.	62	15.7	33.3
SS-U-16-MVCR	1 in.	1 in.	65.8	22.1	41.3

FVCR变径本体

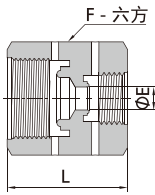

基本型号	端口形式和尺寸		尺寸, mm		
	VCR阴螺纹	VCR阴螺纹	L	E	E
SS-U-4/2-FVCR/FVCR	1/4 in.	1/8 in.	29.5	3.3	19.1
SS-U-8/4-FVCR/FVCR	1/2 in.	1/4 in.	35.8	6.4	27.0

大FVCR转小MVCR直通本体

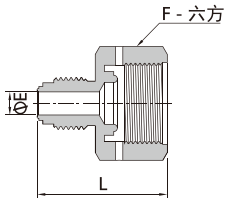

基本型号	端口形式和尺寸		尺寸, mm		
	VCR阳螺纹	VCR阴螺纹	L	E	E
SS-U-4/2-MVCR/FVCR	1/8 in.	1/4 in.	30.2	2.3	19.1
SS-U-8/4-MVCR/FVCR	1/4 in.	1/2 in.	35.8	4.6	27

大MVCR转小FVCR直通本体

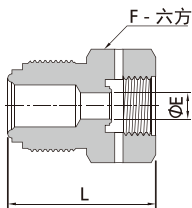

基本型号	端口形式和尺寸		尺寸, mm		
	VCR阳螺纹	VCR阴螺纹	L	E	E
SS-U-4/2-MVCR/FVCR	1/4 in.	1/8 in.	26.9	3.3	15.9
SS-U-8/4-MVCR/FVCR	1/2 in.	1/4 in.	35.8	6.4	23.8

MVCR转NPT弯通本体

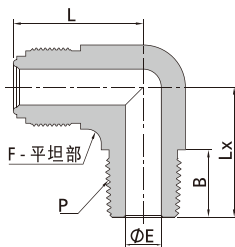

基本型号	端口形式和尺寸		尺寸, mm				
	VCR阳螺纹	VCR阴螺纹	L	LX	B	E	F
SS-L-4/2-MVCR/M	1/4 in.	1/8 in.	27.2	22.1	9.6	4.6	12.7
SS-L-4/4-MVCR/M	1/4 in.	1/4 in.	27.2	26.7	14.2	4.6	12.7
SS-L-8/6-MVCR/M	1/2 in.	3/8 in.	36.8	32	14.2	10.2	20.6
SS-L-8/8-MVCR/M	1/2 in.	1/2 in.	36.8	36.8	19.1	10.2	20.6

MVCR弯通本体

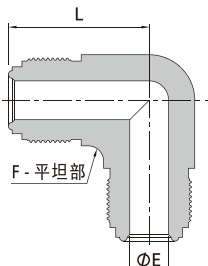

基本型号	端口形式和尺寸	尺寸, mm		
	VCR阳螺纹	L	E	F
SS-L-2-MVCR	1/8 in.	22.6	2.3	11.1
SS-L-4-MVCR	1/4 in.	27.2	4.6	12.7
SS-L-8-MVCR	1/2 in.	36.8	10.2	20.6
SS-L-12-MVCR	3/4 in.	48.8	15.7	31.8
SS-L-16-MVCR	1 in.	50.8	22.1	42.9

MVCR三通本体

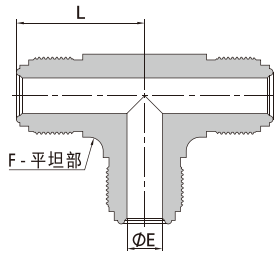

基本型号	端口形式和尺寸		尺寸, mm		
	VCR阳螺纹		L	E	F
SS-T-2-MVCR	1/8 in.		22.6	2.3	11.1
SS-T-4-MVCR	1/4 in.		27.2	4.6	12.7
SS-T-8-MVCR	1/2 in.		36.8	10.2	20.6
SS-T-12-MVCR	3/4 in.		48.8	15.7	31.8
SS-T-16-MVCR	1 in.		50.8	22.1	42.9

MVCR四通本体

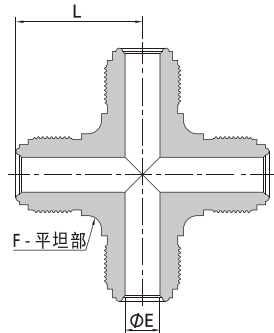

基本型号	端口形式和尺寸		尺寸, mm		
	VCR阳螺纹		L	E	F
SS-C-2-MVCR	1/8 in.		22.6	2.3	11.1
SS-C-4-MVCR	1/4 in.		27.2	4.6	12.7
SS-C-8-MVCR	1/2 in.		36.8	10.2	20.6
SS-C-12-MVCR	3/4 in.		48.8	15.7	31.8
SS-C-16-MVCR	1 in.		50.8	22.1	42.9

FVCR转MNPT活接

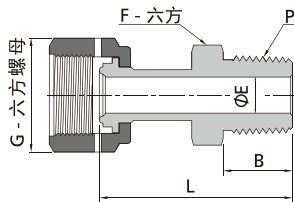

基本型号	端口形式和尺寸		尺寸, mm				
	VCR阴螺纹	NPT阳螺纹	L	B	E	G	F
SS-U-4/2-UFVCR/M	1/4 in.	1/8 in.	40.1	9.7	4.6	19.1	11.1
SS-U-4/4-UFVCR/M	1/4 in.	1/4 in.	45.5	14.2	4.6	19.1	14.3
SS-U-8/6-UFVCR/M	1/2 in.	3/8 in.	48	14.2	10.2	27	17.5
SS-U-8/8-UFVCR/M	1/2 in.	1/2 in.	53.1	19.1	10.2	27	22.2

FVCR转FNPT活接

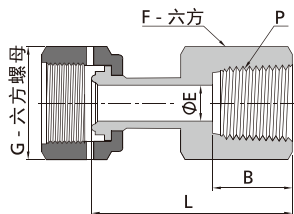

基本型号	端口形式和尺寸		尺寸, mm				
	VCR阴螺纹	NPT阴螺纹	L	B	E	G	F
SS-U-4/4-UFVCR/F	1/4 in.	1/4 in.	45	15	4.6	19.1	19.1
SS-U-8/6-UFVCR/F	1/2 in.	3/8 in.	49.5	15	10.2	27	22.2
SS-U-8/8-UFVCR/F	1/2 in.	1/2 in.	55.4	19.8	10.2	27	27

FVCR转卡套活接

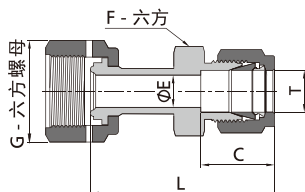

基本型号	端口形式和尺寸		尺寸, mm				
	VCR阴螺纹	NPT阴螺纹	L	B	E	G	F
SS-U-4/4-UFVCR/A	1/4 in.	1/4 in.	49.3	15.2	4.6	19.1	12.7
SS-U-4/6-UFVCR/A	1/4 in.	3/8 in.	50	16.8	4.6	19.1	15.9
SS-U-8/8-UFVCR/A	1/2 in.	1/2 in.	56.6	22.9	10.2	27	20.6

FVCR活接

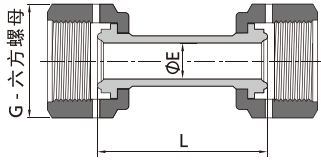

基本型号	端口形式和尺寸	尺寸, mm		
	VCR阳螺纹	L	E	G
SS-U-4-UFVCR	1/4 in.	43.4	4.6	19.1
SS-U-8-UFVCR	1/2 in.	46.7	10.2	27

FVCR螺母

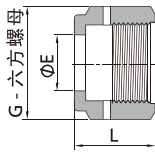

基本型号	端口形式和尺寸	尺寸, mm		
	VCR阳螺纹	L	E	G
SS-N-2-FVCR	1/8 in.	13.5	5.3	11.1
SS-N-4-FVCR	1/4 in.	20.6	9.1	19.1
SS-N-8-FVCR	1/2 in.	22.4	15.5	27
SS-N-10-FVCR	5/8 in.	22.4	18.8	30.2
SS-N-12-FVCR	3/4 in.	28.4	22.6	38.1
SS-N-16-FVCR	1 in.	34	30.5	44.5

MVCR螺母

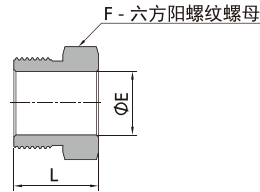

基本型号	端口形式和尺寸	尺寸, mm		
	VCR阳螺纹	L	E	G
SS-N-2-MVCR	1/8 in.	12.7	5.3	9.5
SS-N-4-MVCR	1/4 in.	18	9.1	15.9
SS-N-8-MVCR	1/2 in.	20.6	15.5	23.8
SS-N-10-MVCR	5/8 in.	20.6	18.8	27
SS-N-12-MVCR	3/4 in.	25.4	22.6	33.3
SS-N-16-MVCR	1 in.	30.2	30.5	41.3

堵帽

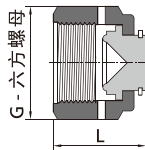

基本型号	端口形式和尺寸	尺寸, mm	
	VCR阳螺纹	L	G
SS-PC-2-VCR	1/8 in.	16	11.1
SS-PC-4-VCR	1/4 in.	23.9	19.1
SS-PC-8-VCR	1/2 in.	25.6	27
SS-PC-12-VCR	3/4 in.	32.8	38.1
SS-PC-16-VCR	1 in.	39.1	44.5

堵头

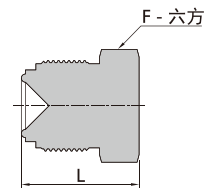

基本型号	端口形式和尺寸	尺寸, mm	
	VCR阳螺纹	L	F
SS-PP-2-MVCR	1/8 in.	17.3	9.5
SS-PP-4-MVCR	1/4 in.	23.4	15.9
SS-PP-8-MVCR	1/2 in.	27.4	23.8
SS-PP-12-MVCR	3/4 in.	36.3	33.3
SS-PP-16-MVCR	1 in.	38.6	41.3

平垫片

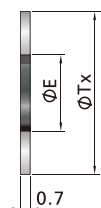

基本型号	端口形式和尺寸		尺寸, mm	
	VCR	TX	E	
SS-GT-2-VCR	1/8 in.	6.6	2.3	
SS-GT-4-VCR	1/4 in.	11.9	5.6	
SS-GT-8-VCR	1/2 in.	19.8	11.2	
SS-GT-10-VCR	5/8 in.	23.1	14.7	
SS-GT-12-VCR	3/4 in.	29	16.8	
SS-GT-16-VCR	1 in.	35.6	22.6	

垫片支撑组件

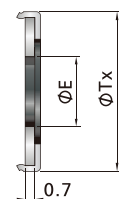

基本型号	端口形式和尺寸		尺寸, mm	
	VCR	TX	E	
SS-GT-4-VCR-R-UP	1/4 in.	12.7	6.1	
SS-GT-8-VCR-R-UP	1/2 in.	20.1	11.2	
SS-GT-12-VCR-R-UP	3/4 in.	29	16.8	
SS-GT-16-VCR-R-UP	1 in.	35.6	22.6	

垫片侧支撑组件

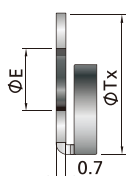

基本型号	端口形式和尺寸		尺寸, mm	
	VCR	TX	T	
SS-GT-4-VCR-SR-UP	1/4 in.	11.4	6.1	
SS-GT-8-VCR-SR-UP	1/2 in.	19.1	11	

盲垫片



基本型号	端口形式和尺寸		尺寸, mm	
	VCR	E		
SS-BG-2-VCR	1/8 in.	2.3		
SS-BG-4-VCR	1/4 in.	5.6		
SS-BG-8-VCR	1/2 in.	11.2		
SS-BG-10-VCR	5/8 in.	14.7		
SS-BG-12-VCR	3/4 in.	16.8		
SS-BG-16-VCR	1 in.	22.6		

注：垫片型号默认为316材质，不镀银，如需镀银在型号后加后缀-SP；如需镍垫片，把型号中的SS改为NI。

选型说明

SS - U - 4/4 - VCR/TB - EP
 端口1/端口2 端口1/端口2

本体材质		接头类型		端口尺寸		端口形式		洁净等级	
SS	316SS	U	直通	2	1/8 in.	VCR	VCR密封		BA级
316L	316LSS	B	穿板接头	4	1/4 in.	MVCR	阳螺纹VCR密封面	EP	EP级
316LV	316L VAR SS	BG	盲焊管	6	3/8 in.	FVCR	阴螺纹VCR密封面		
316LW	316L VIM-VAR SS	L	弯通接头	8	1/2 in.	A	双卡套		
		T	三通接头	10	5/8 in.	M	NPT阳螺纹		
		C	四通接头	12	3/4 in.	F	NPT阴螺纹		
		CT	立体三通	16	1 in.	RC	ISO RC锥管阳螺纹		
				6M	6mm	FRC	ISO RC锥管阴螺纹		
				8M	8mm	TB	自动焊对焊		
				10M	10mm	TBL	阳螺母用自动焊对焊		
				12M	12mm	TS	自动焊插焊		
				14M	14mm	TBA	自动焊中对对焊		
				16M	16mm	TBLA	阳螺母用自动焊中对对焊		
				18M	18mm	TBS	自动焊外焊		
						TA	卡套管		
						UMVCR	阳螺纹活接VCR密封面		
						UFVCR	阴螺纹活接VCR密封面		