

20系列中压锥面螺纹接头

- 工作压力: 1379 bar (20000 psig)
- 工作温度范围: -252°C至649°C (-423°F 至1200°F)
- 用于连接T20系列无缝直管, 适用于外径为1/4"、3/8"、9/16"、3/4"和1"的无缝直管
- 高强度316不锈钢材质

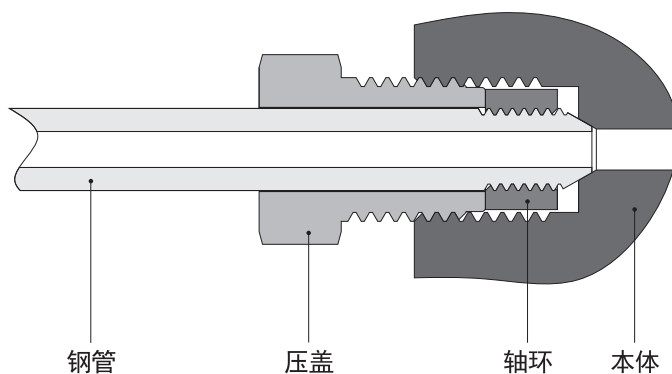

结构材料



注: 所有组件均为不锈钢材质

20中压螺纹直通接头

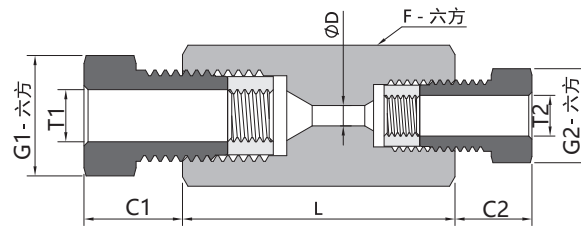

型号	接口类型和尺寸		尺寸 mm							
	端口1	端口2	L	C1	C2	E	F	G1	G2	
SS-20U-4-20S	1/4in. 20系列中压锥面螺纹	1/4in. 20系列中压锥面螺纹	41.1	9.7	9.7	2.8	12.7	15.9	15.9	
SS-20U-6-20S	3/8in. 20系列中压锥面螺纹	3/8in. 20系列中压锥面螺纹	44.5	11.2	11.2	5.1	15.9	19.1	19.1	
SS-20U-9-20S	9/16in. 20系列中压锥面螺纹	9/16in. 20系列中压锥面螺纹	54.3	14	14	7.9	23.8	25.4	25.4	
SS-20U-12-20S	3/4in. 20系列中压锥面螺纹	3/4in. 20系列中压锥面螺纹	63.5	15.2	15.2	11.1	30.2	34.9	34.9	
SS-20U-16-20S	1in. 20系列中压锥面螺纹	1in. 20系列中压锥面螺纹	88.9	18.7	18.7	14.3	34.9	44.5	44.5	
SS-20U-6/4-20S/20S	3/8in. 20系列中压锥面螺纹	1/4in. 20系列中压锥面螺纹	44.5	11.2	9.7	2.8	15.9	12.7	19.1	
SS-20U-9/4-20S/20S	9/16in. 20系列中压锥面螺纹	1/4in. 20系列中压锥面螺纹	50.8	14	9.7	2.8	23.8	12.7	25.4	
SS-20U-9/6-20S/20S	9/16in. 20系列中压锥面螺纹	3/8in. 20系列中压锥面螺纹	50.8	14	11.2	5.1	23.8	15.9	25.4	
SS-20U-12/4-20S/20S	3/4in. 20系列中压锥面螺纹	1/4in. 20系列中压锥面螺纹	57.2	15.2	9.7	2.8	30.2	12.7	34.9	
SS-20U-12/6-20S/20S	3/4in. 20系列中压锥面螺纹	3/8in. 20系列中压锥面螺纹	57.2	15.2	11.2	5.1	30.2	15.9	34.9	
SS-20U-12/9-20S/20S	3/4in. 20系列中压锥面螺纹	9/16in. 20系列中压锥面螺纹	63.5	15.2	14	7.9	30.2	23.8	34.9	
SS-20U-16/4-20S/20S	1in. 20系列中压锥面螺纹	1/4in. 20系列中压锥面螺纹	69.9	18.7	9.7	2.8	34.9	12.7	44.5	
SS-20U-16/6-20S/20S	1in. 20系列中压锥面螺纹	3/8in. 20系列中压锥面螺纹	73	18.7	11.2	5.1	34.9	15.9	44.5	
SS-20U-16/9-20S/20S	1in. 20系列中压锥面螺纹	9/16in. 20系列中压锥面螺纹	76.2	18.7	14	7.9	34.9	23.8	44.5	
SS-20U-16/12-20S/20S	1in. 20系列中压锥面螺纹	3/4in. 20系列中压锥面螺纹	76.2	18.7	15.2	11.1	34.9	30.2	44.5	

A

20中压螺纹滑块直通接头

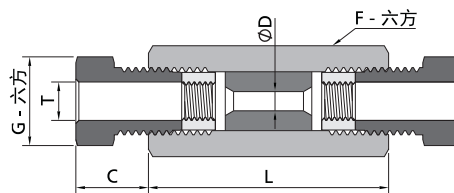

型号	接口类型和尺寸	尺寸 mm				
		L	C	D	E	F
SS-20SU-4-20S	1/4in. 20系列中压锥面螺纹	41.1	9.7	2.8	12.7	15.9
SS-20SU-6-20S	3/8in. 20系列中压锥面螺纹	44.5	11.2	5.1	15.9	19.1
SS-20SU-9-20S	9/16in. 20系列中压锥面螺纹	54.3	14	7.9	23.8	25.4
SS-20SU-12-20S	3/4in. 20系列中压锥面螺纹	63.5	15.2	11.1	30.2	34.9
SS-20SU-16-20S	1in. 20系列中压锥面螺纹	88.9	18.7	14.3	34.9	44.5

20中压螺纹穿板直通接头

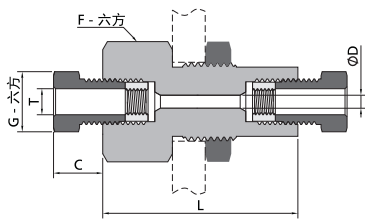

型号	接口类型和尺寸	尺寸 mm						
		L	C	D	E	F	面板孔尺寸	最大面板厚度
SS-20B-4-20S	1/4in. 20系列中压锥面螺纹	47.8	9.7	2.8	12.7	25.4	20.6	9.7
SS-20B-6-20S	3/8in. 20系列中压锥面螺纹	50.8	11.2	5.1	15.9	27	23.9	9.7
SS-20B-9-20S	9/16in. 20系列中压锥面螺纹	60.5	14	7.9	23.8	34.9	28.6	9.7
SS-20B-12-20S	3/4in. 20系列中压锥面螺纹	66.5	15.2	11.1	30.2	47.6	42.9	9.7
SS-20B-16-20S	1in. 20系列中压锥面螺纹	88.9	18.7	14.3	34.9	54	49.3	9.7

20中压螺纹弯通接头

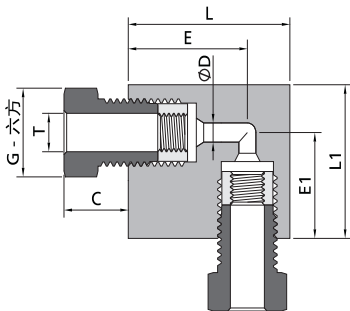

型号	接口类型和尺寸	尺寸 mm								
		C	D	G	L	E	L1	E1	厚度	
SS-20L-4-20S	1/4in. 20系列中压锥面螺纹	9.7	2.8	12.7	28.4	19.1	28.4	19.1	15.9	
SS-20L-6-20S	3/8in. 20系列中压锥面螺纹	11.2	5.1	15.9	34.9	25.4	34.9	25.4	19.1	
SS-20L-9-20S	9/16in. 20系列中压锥面螺纹	14	7.9	23.8	44.5	31.8	44.5	31.8	25.4	
SS-20L-12-20S	3/4in. 20系列中压锥面螺纹	15.2	11.1	30.2	57.2	38.1	57.2	38.1	34.9	
SS-20L-16-20S	1in. 20系列中压锥面螺纹	18.7	14.3	34.9	76.2	52.3	76.2	52.3	44.5	

20中压螺纹三通接头

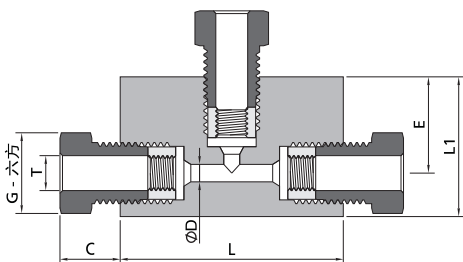

型号	接口类型和尺寸	尺寸 mm							
		C	D	G	L	L1	E	厚度	
SS-20T-4-20S	1/4in. 20系列中压锥面螺纹	9.7	2.8	12.7	38.1	28.4	19.1	15.9	
SS-20T-6-20S	3/8in. 20系列中压锥面螺纹	11.2	5.1	15.9	50.8	34.9	25.4	19.1	
SS-20T-9-20S	9/16in. 20系列中压锥面螺纹	14	7.9	23.8	63.5	44.5	31.8	25.4	
SS-20T-12-20S	3/4in. 20系列中压锥面螺纹	15.2	11.1	30.2	76.2	57.2	38.1	34.9	
SS-20T-16-20S	1in. 20系列中压锥面螺纹	18.7	14.3	34.9	105	76.2	52.3	44.5	

20中压螺纹四通接头

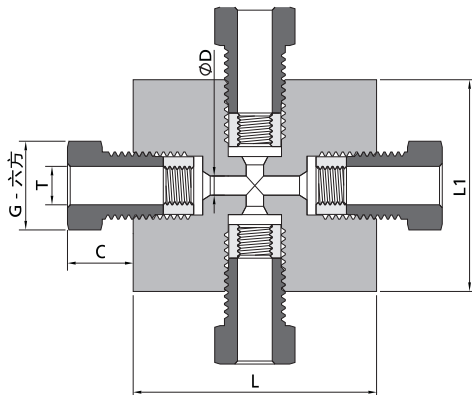

型号	接口类型和尺寸	尺寸 mm					
		C	D	G	L	L1	厚度
SS-20C-4-20S	1/4in. 20系列中压锥面螺纹	9.7	2.8	12.7	38.1	38.1	15.9
SS-20C-6-20S	3/8in. 20系列中压锥面螺纹	11.2	5.1	15.9	50.8	50.8	19.1
SS-20C-9-20S	9/16in. 20系列中压锥面螺纹	14	7.9	23.8	63.5	63.5	25.4
SS-20C-12-20S	3/4in. 20系列中压锥面螺纹	15.2	11.1	30.2	76.2	76.2	34.9
SS-20C-16-20S	1in. 20系列中压锥面螺纹	18.7	14.3	34.9	105	105	44.5

20压盖

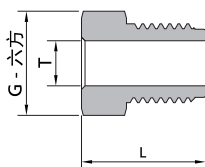

型号	接管尺寸	尺寸 mm	
		G	L
SS-20G-4	1/4in.	12.7	14.7
SS-20G-6	3/8in.	15.9	18.5
SS-20G-9	9/16in.	23.8	22.4
SS-20G-12	3/4in.	30.2	25.4
SS-20G-16	1in.	34.9	35.1

20轴环

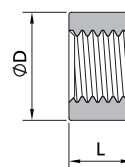

型号	接管尺寸	尺寸 mm	
		G	L
SS-20CO-4	1/4in.	9.7	5.6
SS-20CO-6	3/8in.	11.9	6.4
SS-20CO-9	9/16in.	18.3	7.9
SS-20CO-12	3/4in.	23.8	9.4
SS-20CO-16	1in.	31.8	12.7

20管帽

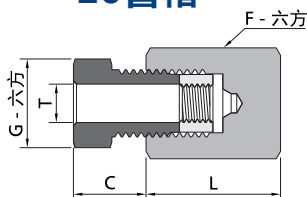

型号	接管尺寸	尺寸 mm			
		L	C	G	F
SS-20TC-4	1/4in.	20.6	9.7	12.7	15.9
SS-20TC-6	3/8in.	28.6	11.2	15.9	19.1
SS-20TC-9	9/16in.	34.9	14	23.8	25.4
SS-20TC-12	3/4in.	44.5	15.2	30.2	34.9
SS-20TC-16	1in.	57.2	18.7	34.9	44.5

20堵头

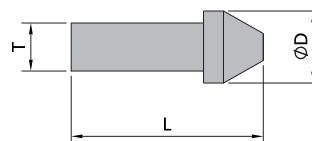

型号	接管尺寸	尺寸 mm	
		G	L
SS-20TP-4	1/4in.	9.7	23.8
SS-20TP-6	3/8in.	11.9	30
SS-20TP-9	9/16in.	18.3	35.6
SS-20TP-12	3/4in.	23.8	42.9
SS-20TP-16	1in.	31.8	55.9

A

订购信息

SS

20U

4

20S

阀体材质	
SS	316SS

系列	
20U	直通
20SU	滑块直通
20B	穿板
20L	弯通
20T	三通
20C	四通
20G	压盖
20CO	轴环
20TC	管帽
20TP	堵头

端口尺寸	
2	1/8 in.
4	1/4 in.
6	3/8 in.
9	9/16 in.
12	3/4 in.
16	1 in.

端口形式	
20S	20系列中压锥面螺纹组件

注：产品型号仅做参考，不能随意组合，具体型号以最终技术确认为准。

60系列高压锥面螺纹接头

- 工作压力: 4137 bar (60000 psig)
- 工作温度范围: -252°C至649°C (-423°F至1200°F)
- 用于连接T60系列无缝直管, 适用于外径为1/4"、3/8"和9/16"的无缝直管
- 高强度316不锈钢材质



结构材料

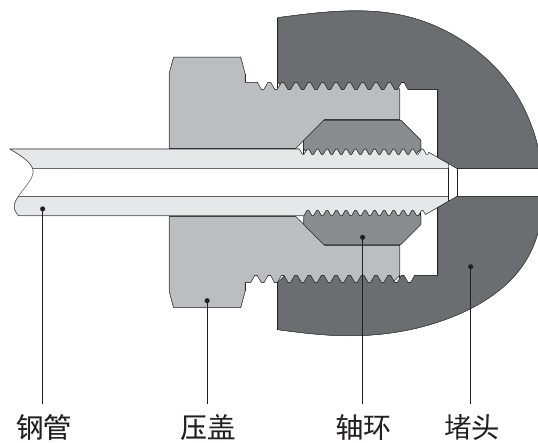

注: 所有组件均为不锈钢材质

60高压螺纹直通接头

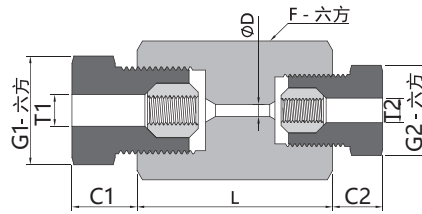

型号	接口类型和尺寸		尺寸 mm						
	端口1	端口2	L	C1	C2	D	G1	G2	F
SS-60U-4-60S	1/4in.60系列高压锥面螺纹	1/4in.60系列高压锥面螺纹	34.9	11.9	11.9	2.3	15.9	15.9	19.1
SS-60U-6-60S	3/8in.60系列高压锥面螺纹	3/8in.60系列高压锥面螺纹	44.5	15.6	15.6	3.3	20.6	20.6	25.4
SS-60U-9-60S	9/16in.60系列高压锥面螺纹	9/16in.60系列高压锥面螺纹	55.6	24.1	24.1	4.8	30.2	30.2	34.9
SS-60U-6/4-60S/60S	3/8in.60系列高压锥面螺纹	1/4in.60系列高压锥面螺纹	41.3	15.6	11.9	2.3	20.6	15.9	25.4
SS-60U-9/4-60S/60S	9/16in.60系列高压锥面螺纹	1/4in.60系列高压锥面螺纹	44.5	24.1	11.9	2.3	30.2	15.9	34.9
SS-60U-9/6-60S/60S	9/16in.60系列高压锥面螺纹	3/8in.60系列高压锥面螺纹	50.8	24.1	15.6	3.3	30.2	20.6	34.9

60高压螺纹滑块直通接头

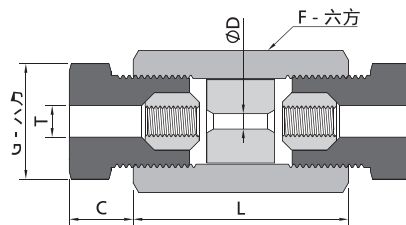

型号	接口类型和尺寸	尺寸 mm				
		L	C	D	G	F
SS-60SU-4-60S	1/4in.60系列高压锥面螺纹	34.9	11.9	2.3	15.9	19.1
SS-60SU-6-60S	3/8in.60系列高压锥面螺纹	44.5	15.6	3.3	20.6	25.4
SS-60SU-9-60S	9/16in.60系列高压锥面螺纹	55.6	24.1	4.8	30.2	34.9

60高压螺纹穿板直通接头

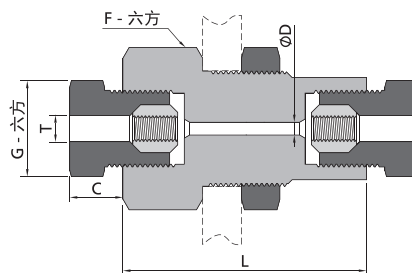

型号	接口类型和尺寸	尺寸 mm						
		L	C	D	G	F	面板孔尺寸	最大面板厚度
SS-60B-4-60S	1/4in.60系列高压锥面螺纹	47.8	11.9	2.3	15.9	27	23.9	9.7
SS-60B-6-60S	3/8in.60系列高压锥面螺纹	60.5	15.6	3.3	20.6	34.9	28.6	9.7
SS-60B-9-60S	9/16in.60系列高压锥面螺纹	69.9	24.1	4.8	30.2	47.6	42.9	9.7

60高压螺纹弯通接头

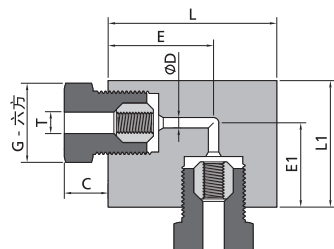

型号	接口类型和尺寸	尺寸 mm							
		C	D	G	L1	L2	E1	E2	厚度
SS-60L-4-60S	1/4in.60系列高压锥面螺纹	11.9	2.3	15.9	38.1	25.4	22.4	15.7	19.1
SS-60L-6-60S	3/8in.60系列高压锥面螺纹	15.6	3.3	20.6	50.8	38.1	31.8	25.4	25.4
SS-60L-9-60S	9/16in.60系列高压锥面螺纹	24.1	4.8	30.2	66.5	47.8	47.8	28.4	38.1

A

60高压螺纹三通接头

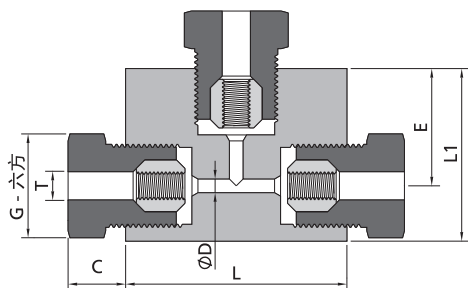

型号	接口类型和尺寸	尺寸 mm						
		C	D	G	L	L1	E	厚度
SS-60T-4-60S	1/4in.60系列高压锥面螺纹	11.9	2.3	15.9	50.8	31.8	22.4	19.1
SS-60T-6-60S	3/8in.60系列高压锥面螺纹	15.6	3.3	20.6	50.8	39.6	26.9	25.4
SS-60T-9-60S	9/16in.60系列高压锥面螺纹	24.1	4.8	30.2	66.5	53.8	35	38.1

60高压螺纹四通接头

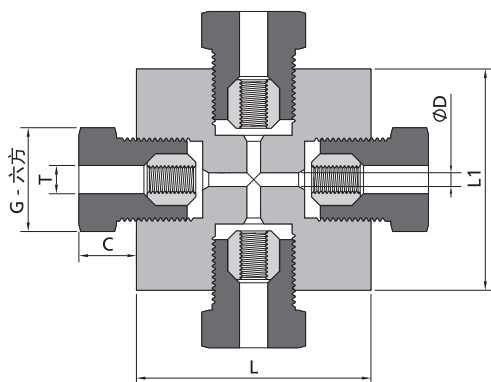

型号	接口类型和尺寸	尺寸 mm					
		C	D	G	L	L1	厚度
SS-60C-4-60S	1/4in.60系列高压锥面螺纹	11.9	2.3	15.9	50.8	31.8	19.1
SS-60C-6-60S	3/8in.60系列高压锥面螺纹	15.6	3.3	20.6	50.8	53.8	25.4
SS-60C-9-60S	9/16in.60系列高压锥面螺纹	24.1	4.8	30.2	66.5	69.9	38.1

60压盖

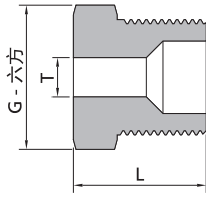

型号	接管尺寸 in.	尺寸 mm	
		C	D
SS-60G-4	1/4	15.9	20.8
SS-60G-6	3/8	20.6	28.7
SS-60G-6	9/16	30.2	38.1

60轴环

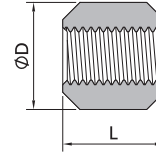

型号	接管尺寸 in.	尺寸 mm	
		C	D
SS-60CO-4	1/4	9.6	9.6
SS-60CO-6	3/8	12.7	13.7
SS-60CO-6	9/16	20.6	15.8

60管帽

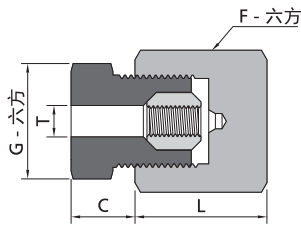

型号	接管尺寸 in.	尺寸 mm			
		L	C	G	F
SS-60TC-4	1/4	19.1	11.9	15.9	19.1
SS-60TC-6	3/8	28.6	15.6	20.6	25.4
SS-60TC-6	9/16	34.9	24.1	30.2	34.9

60堵头

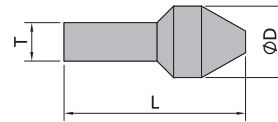

型号	接管尺寸 in.	尺寸 mm	
		C	D
SS-60TP-4	1/4	9.6	26.4
SS-60TP-6	3/8	12.7	34.3
SS-60TP-6	9/16	20.6	48

A

订购信息

SS

60U

4

60S

阀体材质
SS 316SS

系列	
60U	直通
60SU	滑块直通
60B	穿板
60L	弯通
60T	三通
60C	四通
60G	压盖
60CO	轴环
60TC	管帽
60TP	堵头

端口尺寸	
4	1/4in.
6	3/8 in.
9	9/16 in.

端口形式	
60S	60系列高压锥面螺纹组件

注：产品型号仅做参考，不能随意组合，具体型号以最终技术确认为准。

中高压转换接头

60高压锥面螺纹-20中压锥面螺纹

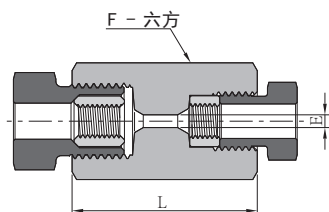

型号	端口1	端口2	尺寸, mm			工作压力 psi (bar)
			L	F	E	
SS-60U-4/4-60S/20S	1/4"60高压锥面螺纹	1/4"20中压锥面螺纹	34.9	19.1	2.4	20000 (1379)
SS-60U-4/6-60S/20S	1/4"60高压锥面螺纹	3/8"20中压锥面螺纹	39.7	19.1	2.4	20000 (1379)
SS-60U-4/9-60S/20S	1/4"60高压锥面螺纹	9/16"20中压锥面螺纹	46	25.4	2.4	20000 (1379)
SS-60U-4/12-60S/20S	1/4"60高压锥面螺纹	3/4"20中压锥面螺纹	52.4	34.9	2.4	20000 (1379)
SS-60U-4/16-60S/20S	1/4"60高压锥面螺纹	1"20中压锥面螺纹	65.1	44.5	2.4	20000 (1379)
SS-60U-6/4-60S/20S	3/8"60高压锥面螺纹	1/4"20中压锥面螺纹	41.3	25.4	2.8	20000 (1379)
SS-60U-6/6-60S/20S	3/8"60高压锥面螺纹	3/8"20中压锥面螺纹	46	25.4	3.2	20000 (1379)
SS-60U-6/9-60S/20S	3/8"60高压锥面螺纹	9/16"20中压锥面螺纹	52.4	25.4	3.2	20000 (1379)
SS-60U-6/12-60S/20S	3/8"60高压锥面螺纹	3/4"20中压锥面螺纹	58.7	34.9	3.2	20000 (1379)
SS-60U-6/16-60S/20S	3/8"60高压锥面螺纹	1"20中压锥面螺纹	71.4	44.5	3.2	20000 (1379)
SS-60U-9/4-60S/20S	9/16"60高压锥面螺纹	1/4"20中压锥面螺纹	46	34.9	2.8	20000 (1379)
SS-60U-9/6-60S/20S	9/16"60高压锥面螺纹	3/8"20中压锥面螺纹	49.2	34.9	4.8	20000 (1379)
SS-60U-9/9-60S/20S	9/16"60高压锥面螺纹	9/16"20中压锥面螺纹	57.2	34.9	4.8	20000 (1379)
SS-60U-9/12-60S/20S	9/16"60高压锥面螺纹	3/4"20中压锥面螺纹	61.9	34.9	4.8	20000 (1379)
SS-60U-9/16-60S/20S	9/16"60高压锥面螺纹	1"20中压锥面螺纹	76.2	44.5	4.8	20000 (1379)

60高压锥面螺纹-60高压螺纹管

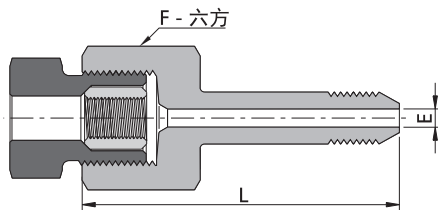

型号	端口1	端口2	尺寸, mm			工作压力 psi (bar)
			L	F	E	
SS-60U-4/4-60S/T60	1/4"60高压锥面螺纹	1/4"60高压螺纹管	49	19.1	2.1	60000 (4137)
SS-60U-4/6-60S/T60	1/4"60高压锥面螺纹	3/8"60高压螺纹管	59	19.1	2.4	60000 (4137)
SS-60U-4/9-60S/T60	1/4"60高压锥面螺纹	9/16"60高压螺纹管	74	19.1	2.4	60000 (4137)
SS-60U-6/4-60S/T60	3/8"60高压锥面螺纹	1/4"60高压螺纹管	56	25.4	2.1	60000 (4137)
SS-60U-6/6-60S/T60	3/8"60高压锥面螺纹	3/8"60高压螺纹管	66	25.4	3.2	60000 (4137)
SS-60U-6/9-60S/T60	3/8"60高压锥面螺纹	9/16"60高压螺纹管	81	25.4	3.2	60000 (4137)
SS-60U-9/4-60S/T60	9/16"60高压锥面螺纹	1/4"60高压螺纹管	63	34.9	2.1	60000 (4137)
SS-60U-9/6-60S/T60	9/16"60高压锥面螺纹	3/8"60高压螺纹管	73	34.9	3.2	60000 (4137)
SS-60U-9/9-60S/T60	9/16"60高压锥面螺纹	9/16"60高压螺纹管	88	34.9	4.8	60000 (4137)

20中压锥面螺纹-20中压螺纹管

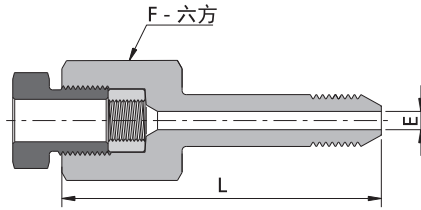

型号	端口1	端口2	尺寸, mm			工作压力 psi (bar)
			L	F	E	
SS-20U-4/4-20S/T20	1/4"20中压锥面螺纹	1/4"20中压阳螺纹管	41.4	15.9	2.8	20000 (1379)
SS-20U-4/6-20S/T20	1/4"20中压锥面螺纹	3/8"20中压阳螺纹管	47.8	15.9	2.8	20000 (1379)
SS-20U-4/9-20S/T20	1/4"20中压锥面螺纹	9/16"20中压阳螺纹管	53.1	17.5	2.8	20000 (1379)
SS-20U-6/4-20S/T20	3/8"20中压锥面螺纹	1/4"20中压阳螺纹管	48	19.1	2.8	20000 (1379)
SS-20U-6/6-20S/20T	3/8"20中压锥面螺纹	3/8"20中压阳螺纹管	54.4	19.1	5.2	20000 (1379)
SS-20U-6/9-20S/T20	3/8"20中压锥面螺纹	9/16"20中压阳螺纹管	59.7	19.1	5.2	20000 (1379)
SS-20U-9/4-20S/T20	9/16"20中压锥面螺纹	1/4"20中压阳螺纹管	56	25.4	2.8	20000 (1379)
SS-20U-9/6-20S/T20	9/16"20中压锥面螺纹	3/8"20中压阳螺纹管	62.4	25.4	5.2	20000 (1379)
SS-20U-9/9-20S/T20	9/16"20中压锥面螺纹	9/16"20中压阳螺纹管	67.7	25.4	7.9	20000 (1379)
SS-20U-9/12-20S/T20	9/16"20中压锥面螺纹	3/4"20中压阳螺纹管	74	25.4	7.9	20000 (1379)
SS-20U-9/16-20S/T20	9/16"20中压锥面螺纹	1"20中压阳螺纹管	87.6	28.6	7.9	20000 (1379)
SS-20U-12/9-20S/T20	3/4"20中压锥面螺纹	9/16"20中压阳螺纹管	74.7	34.9	7.9	20000 (1379)
SS-20U-12/12-20S/20T	3/4"20中压锥面螺纹	3/4"20中压阳螺纹管	81	34.9	11.1	20000 (1379)
SS-20U-12/16-20S/T20	3/4"20中压锥面螺纹	1"20中压阳螺纹管	94.6	34.9	11.1	20000 (1379)
SS-20U-16/9-20S/T20	1"20中压锥面螺纹	9/16"20中压阳螺纹管	88.7	44.5	7.9	20000 (1379)
SS-20U-16/12-20S/T20	1"20中压锥面螺纹	3/4"20中压阳螺纹管	95	44.5	11.1	20000 (1379)
SS-20U-16/12-20S/T20	1"20中压锥面螺纹	1"20中压阳螺纹管	108.6	44.5	14.3	20000 (1379)

60高压锥面螺纹-60高压锥面阳螺纹

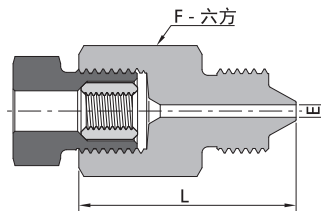

型号	端口1	端口2	尺寸, mm			工作压力 psi (bar)
			L	F	E	
SS-60U-4/4-60S/60M	1/4"60高压锥面螺纹	1/4"60高压锥面阳螺纹	36.5	19.1	2.1	60000 (4137)
SS-60U-4/6-60S/60M	1/4"60高压锥面螺纹	3/8"60高压锥面阳螺纹	42.9	20.6	2.4	60000 (4137)
SS-60U-4/9-60S/60M	1/4"60高压锥面螺纹	9/16"60高压锥面阳螺纹	44.5	30.2	2.4	60000 (4137)
SS-60U-6/4-60S/60M	3/8"60高压锥面螺纹	1/4"60高压锥面阳螺纹	44.5	25.4	2.1	60000 (4137)
SS-60U-6/6-60S/60M	3/8"60高压锥面螺纹	3/8"60高压锥面阳螺纹	50.8	25.4	3.2	60000 (4137)
SS-60U-6/9-60S/60M	3/8"60高压锥面螺纹	9/16"60高压锥面阳螺纹	54	30.2	3.2	60000 (4137)
SS-60U-9/4-60S/60M	9/16"60高压锥面螺纹	1/4"60高压锥面阳螺纹	52.4	34.9	2.1	60000 (4137)
SS-60U-9/6-60S/60M	9/16"60高压锥面螺纹	3/8"60高压锥面阳螺纹	60.3	34.9	3.2	60000 (4137)
SS-60U-9/9-60S/60M	9/16"60高压锥面螺纹	9/16"60高压锥面阳螺纹	63.5	34.9	4.8	60000 (4137)

20中压锥面螺纹-20中压锥面阳螺纹

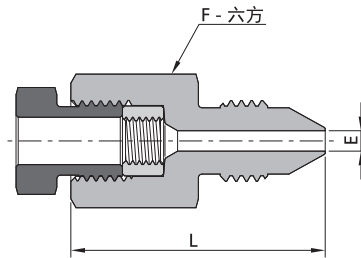

型号	端口1	端口2	尺寸, mm			工作压力 psi (bar)
			L	F	E	
SS-20U-4/4-20S/20M	1/4"20中压锥面螺纹	1/4"20中压锥面阳螺纹	34.9	15.9	2.8	20000 (1379)
SS-20U-4/6-20S/20M	1/4"20中压锥面螺纹	3/8"20中压锥面阳螺纹	38.1	15.9	2.8	20000 (1379)
SS-20U-4/9-20S/20M	1/4"20中压锥面螺纹	9/16"20中压锥面阳螺纹	41.3	23.8	2.8	20000 (1379)
SS-20U-4/12-20S/20M	1/4"20中压锥面螺纹	3/4"20中压锥面阳螺纹	44.5	30.2	2.8	20000 (1379)
SS-20U-4/16-20S/20M	1/4"20中压锥面螺纹	1"20中压锥面阳螺纹	60.3	38.1	2.8	20000 (1379)
SS-20U-6/4-20S/20M	3/8"20中压锥面螺纹	1/4"20中压锥面阳螺纹	42.9	19.1	2.8	20000 (1379)
SS-20U-6/6-20S/20M	3/8"20中压锥面螺纹	3/8"20中压锥面阳螺纹	42.9	19.1	5.2	20000 (1379)
SS-20U-6/9-20S/20M	3/8"20中压锥面螺纹	9/16"20中压锥面阳螺纹	47.6	23.8	5.2	20000 (1379)
SS-20U-6/12-20S/20M	3/8"20中压锥面螺纹	3/4"20中压锥面阳螺纹	49.2	30.2	5.2	20000 (1379)
SS-20U-6/16-20S/20M	3/8"20中压锥面螺纹	1"20中压锥面阳螺纹	60.3	38.1	5.2	20000 (1379)
SS-20U-9/4-20S/20M	9/16"20中压锥面螺纹	1/4"20中压锥面阳螺纹	49.2	25.4	2.8	20000 (1379)
SS-20U-9/6-20S/20M	9/16"20中压锥面螺纹	3/8"20中压锥面阳螺纹	52.4	25.4	5.2	20000 (1379)
SS-20U-9/9-20S/20M	9/16"20中压锥面螺纹	9/16"20中压锥面阳螺纹	54	25.4	7.9	20000 (1379)
SS-20U-9/12-20S/20M	9/16"20中压锥面螺纹	3/4"20中压锥面阳螺纹	57.2	30.2	7.9	20000 (1379)
SS-20U-9/16-20S/20M	9/16"20中压锥面螺纹	1"20中压锥面阳螺纹	63.5	38.1	7.9	20000 (1379)
SS-20U-12/4-20S/20M	3/4"20中压锥面螺纹	1/4"20中压锥面阳螺纹	55.6	34.9	2.8	20000 (1379)
SS-20U-12/6-20S/20M	3/4"20中压锥面螺纹	3/8"20中压锥面阳螺纹	58.7	34.9	5.2	20000 (1379)
SS-20U-12/9-20S/20M	3/4"20中压锥面螺纹	9/16"20中压锥面阳螺纹	61.9	34.9	7.9	20000 (1379)
SS-20U-12/12-20S/20M	3/4"20中压锥面螺纹	3/4"20中压锥面阳螺纹	65.1	34.9	11.1	20000 (1379)
SS-20U-12/16-20S/20M	3/4"20中压锥面螺纹	1"20中压锥面阳螺纹	74.6	38.1	11.1	20000 (1379)
SS-20U-16/9-20S/20M	1"20中压锥面螺纹	9/16"20中压锥面阳螺纹	77.8	44.5	7.9	20000 (1379)
SS-20U-16/12-20S/20M	1"20中压锥面螺纹	3/4"20中压锥面阳螺纹	81	44.5	11.1	20000 (1379)
SS-20U-16/12-20S/20M	1"20中压锥面螺纹	1"20中压锥面阳螺纹	88.9	44.5	14.3	20000 (1379)

60高压锥面螺纹-20中压锥面阳螺纹

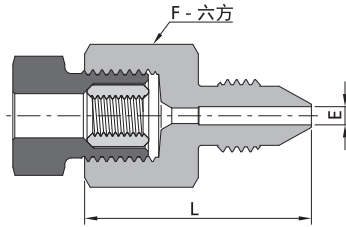

型号	端口1	端口2	尺寸, mm			工作压力 psi (bar)
			L	F	E	
SS-60U-4/4-60S/20M	1/4"60高压锥面螺纹	1/4"20中压锥面阳螺纹	34.9	19.1	2.4	20000 (1379)
SS-60U-4/6-60S/20M	1/4"60高压锥面螺纹	3/8"20中压锥面阳螺纹	38.1	19.1	2.4	20000 (1379)
SS-60U-4/9-60S/20M	1/4"60高压锥面螺纹	9/16"20中压锥面阳螺纹	42.9	23.8	2.4	20000 (1379)
SS-60U-4/12-60S/20M	1/4"60高压锥面螺纹	3/4"20中压锥面阳螺纹	44.5	30.2	2.4	20000 (1379)
SS-60U-4/16-60S/20M	1/4"60高压锥面螺纹	1"20中压锥面阳螺纹	60.3	38.1	2.4	20000 (1379)
SS-60U-6/4-60S/20M	3/8"60高压锥面螺纹	1/4"20中压锥面阳螺纹	42.3	25.4	2.8	20000 (1379)
SS-60U-6/6-60S/20M	3/8"60高压锥面螺纹	3/8"20中压锥面阳螺纹	46	25.4	3.2	20000 (1379)
SS-60U-6/9-60S/20M	3/8"60高压锥面螺纹	9/16"20中压锥面阳螺纹	49.2	25.4	3.2	20000 (1379)
SS-60U-6/12-60S/20M	3/8"60高压锥面螺纹	3/4"20中压锥面阳螺纹	54	30.2	3.2	20000 (1379)
SS-60U-6/16-60S/20M	3/8"60高压锥面螺纹	1"20中压锥面阳螺纹	63.5	38.1	3.2	20000 (1379)
SS-60U-9/4-60S/20M	9/16"60高压锥面螺纹	1/4"20中压锥面阳螺纹	47.6	34.9	2.8	20000 (1379)
SS-60U-9/6-60S/20M	9/16"60高压锥面螺纹	3/8"20中压锥面阳螺纹	50.8	34.9	4.8	20000 (1379)
SS-60U-9/9-60S/20M	9/16"60高压锥面螺纹	9/16"20中压锥面阳螺纹	55.6	34.9	4.8	20000 (1379)
SS-60U-9/12-60S/20M	9/16"60高压锥面螺纹	3/4"20中压锥面阳螺纹	60.3	34.9	4.8	20000 (1379)
SS-60U-9/16-60S/20M	9/16"60高压锥面螺纹	1"20中压锥面阳螺纹	71.4	38.1	4.8	20000 (1379)

20中压锥面螺纹-60高压锥面阳螺纹

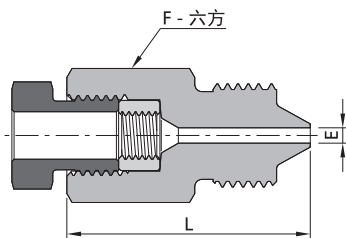

型号	端口1	端口2	尺寸, mm			工作压力 psi (bar)
			L	F	E	
SS-20U-4/4-20S/60M	1/4"20中压锥面螺纹	1/4"60高压锥面阳螺纹	33.3	15.9	2.1	20000 (1379)
SS-20U-4/6-20S/60M	1/4"20中压锥面螺纹	3/8"60高压锥面阳螺纹	38.1	20.6	2.8	20000 (1379)
SS-20U-4/9-20S/60M	1/4"20中压锥面螺纹	9/16"60高压锥面阳螺纹	41.3	30.2	2.8	20000 (1379)
SS-20U-6/4-20S/60M	3/8"20中压锥面螺纹	1/4"60高压锥面阳螺纹	38.1	19.1	2.1	20000 (1379)
SS-20U-6/6-20S/60M	3/8"20中压锥面螺纹	3/8"60高压锥面阳螺纹	42.9	20.6	3.2	20000 (1379)
SS-20U-6/9-20S/60M	3/8"20中压锥面螺纹	9/16"60高压锥面阳螺纹	44.5	30.2	4.8	20000 (1379)
SS-20U-9/4-20S/60M	9/16"20中压锥面螺纹	1/4"60高压锥面阳螺纹	46	25.4	2.1	20000 (1379)
SS-20U-9/6-20S/60M	9/16"20中压锥面螺纹	3/8"60高压锥面阳螺纹	54	25.4	3.2	20000 (1379)
SS-20U-9/9-20S/60M	9/16"20中压锥面螺纹	9/16"60高压锥面阳螺纹	54	30.2	4.8	20000 (1379)
SS-20U-12/4-20S/60M	3/4"20中压锥面螺纹	1/4"60高压锥面阳螺纹	57.2	34.9	2.1	20000 (1379)
SS-20U-12/6-20S/60M	3/4"20中压锥面螺纹	3/8"60高压锥面阳螺纹	63.5	34.9	3.2	20000 (1379)
SS-20U-12/9-20S/60M	3/4"20中压锥面螺纹	9/16"60高压锥面阳螺纹	63.5	34.9	4.8	20000 (1379)
SS-20U-16/4-20S/60M	1"20中压锥面螺纹	1/4"60高压锥面阳螺纹	74.6	44.5	2.1	20000 (1379)
SS-20U-16/6-20S/60M	1"20中压锥面螺纹	3/8"60高压锥面阳螺纹	79.4	44.5	3.2	20000 (1379)
SS-20U-16/9-20S/60M	1"20中压锥面螺纹	9/16"60高压锥面阳螺纹	81	44.5	4.8	20000 (1379)



60高压锥面螺纹-NPT阴螺纹

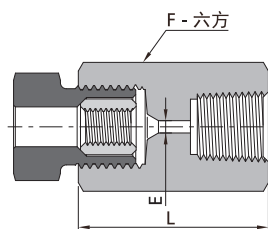

型号	端口1	端口2	尺寸, mm			工作压力 psi (bar)
			L	F	E	
SS-60U-4/2-60S/F	1/4"60高压锥面螺纹	1/8"FNPT	34.9	19.1	2.4	15000 (1034)
SS-60U-4/4-60S/F	1/4"60高压锥面螺纹	1/4"FNPT	41.3	23.8	2.4	15000 (1034)
SS-60U-4/6-60S/F	1/4"60高压锥面螺纹	3/8"FNPT	41.3	28.6	2.4	15000 (1034)
SS-60U-4/8-60S/F	1/4"60高压锥面螺纹	1/2"FNPT	50.8	34.9	2.4	15000 (1034)
SS-60U-4/12-60S/F	1/4"60高压锥面螺纹	3/4"FNPT	50.8	38.1	2.4	10000 (690)
SS-60U-4/16-60S/F	1/4"60高压锥面螺纹	1"FNPT	60.3	44.5	2.4	10000 (690)
SS-60U-6/2-60S/F	3/8"60高压锥面螺纹	1/8"FNPT	41.3	25.4	3.2	15000 (1034)
SS-60U-6/4-60S/F	3/8"60高压锥面螺纹	1/4"FNPT	47.6	25.4	3.2	15000 (1034)
SS-60U-6/6-60S/F	3/8"60高压锥面螺纹	3/8"FNPT	47.6	28.6	3.2	15000 (1034)
SS-60U-6/8-60S/F	3/8"60高压锥面螺纹	1/2"FNPT	54	34.9	3.2	15000 (1034)
SS-60U-6/12-60S/F	3/8"60高压锥面螺纹	3/4"FNPT	54	38.1	3.2	10000 (690)
SS-60U-6/16-60S/F	3/8"60高压锥面螺纹	1"FNPT	57.2	44.5	3.2	10000 (690)
SS-60U-9/2-60S/F	9/16"60高压锥面螺纹	1/8"FNPT	46	34.9	4.8	15000 (1034)
SS-60U-9/4-60S/F	9/16"60高压锥面螺纹	1/4"FNPT	50.8	34.9	4.8	15000 (1034)
SS-60U-9/6-60S/F	9/16"60高压锥面螺纹	3/8"FNPT	50.8	34.9	4.8	15000 (1034)
SS-60U-9/8-60S/F	9/16"60高压锥面螺纹	1/2"FNPT	60.3	34.9	4.8	15000 (1034)
SS-60U-9/12-60S/F	9/16"60高压锥面螺纹	3/4"FNPT	60.3	38.1	4.8	10000 (690)
SS-60U-9/16-60S/F	9/16"60高压锥面螺纹	1"FNPT	63.5	44.5	4.8	10000 (690)

20中压锥面螺纹-NPT阴螺纹

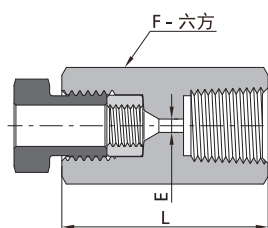

型号	端口1	端口2	尺寸, mm			工作压力 psi (bar)
			L	F	E	
SS-20U-4/2-20S/F	1/4"20中压锥面螺纹	1/8"FNPT	34.9	15.9	2.8	15000 (1034)
SS-20U-4/4-20S/F	1/4"20中压锥面螺纹	1/4"FNPT	41.3	23.8	2.8	15000 (1034)
SS-20U-4/6-20S/F	1/4"20中压锥面螺纹	3/8"FNPT	41.3	28.6	2.8	15000 (1034)
SS-20U-4/8-20S/F	1/4"20中压锥面螺纹	1/2"FNPT	50.8	34.9	2.8	15000 (1034)
SS-20U-6/2-20S/F	3/8"20中压锥面螺纹	1/8"FNPT	38.1	19.1	5.2	15000 (1034)
SS-20U-6/4-20S/F	3/8"20中压锥面螺纹	1/4"FNPT	44.5	23.8	5.2	15000 (1034)
SS-20U-6/6-20S/F	3/8"20中压锥面螺纹	3/8"FNPT	46	28.6	5.2	15000 (1034)
SS-20U-6/8-20S/F	3/8"20中压锥面螺纹	1/2"FNPT	54	34.9	5.2	15000 (1034)
SS-20U-6/12-20S/F	3/8"20中压锥面螺纹	3/4"FNPT	57.2	38.1	5.2	10000 (690)
SS-20U-9/2-20S/F	9/16"20中压锥面螺纹	1/8"FNPT	41.3	25.4	7.9	15000 (1034)
SS-20U-9/4-20S/F	9/16"20中压锥面螺纹	1/4"FNPT	50.8	25.4	7.9	15000 (1034)
SS-20U-9/6-20S/F	9/16"20中压锥面螺纹	3/8"FNPT	50.8	28.6	7.9	15000 (1034)
SS-20U-9/8-20S/F	9/16"20中压锥面螺纹	1/2"FNPT	57.2	34.9	7.9	15000 (1034)
SS-20U-9/12-20S/F	9/16"20中压锥面螺纹	3/4"FNPT	57.2	38.1	7.9	10000 (690)
SS-20U-9/16-20S/F	9/16"20中压锥面螺纹	1"FNPT	66.7	44.5	7.9	10000 (690)
SS-20U-12/8-20S/F	3/4"20中压锥面螺纹	1/8"FNPT	44.5	34.9	8.1	15000 (1034)
SS-20U-12/4-20S/F	3/4"20中压锥面螺纹	1/4"FNPT	50.8	34.9	10.4	15000 (1034)
SS-20U-12/6-20S/F	3/4"20中压锥面螺纹	3/8"FNPT	60.3	34.9	11.1	15000 (1034)
SS-20U-12/8-20S/F	3/4"20中压锥面螺纹	1/2"FNPT	66.7	34.9	11.1	15000 (1034)
SS-20U-12/12-20S/F	3/4"20中压锥面螺纹	3/4"FNPT	66.7	38.1	11.1	10000 (690)
SS-20U-12/16-20S/F	3/4"20中压锥面螺纹	1"FNPT	66.7	44.5	11.1	10000 (690)
SS-20U-16/4-20S/F	1"20中压锥面螺纹	1/4"FNPT	60.3	44.5	10.4	15000 (1034)
SS-20U-16/6-20S/F	1"20中压锥面螺纹	3/8"FNPT	63.5	44.5	13.9	15000 (1034)
SS-20U-16/8-20S/F	1"20中压锥面螺纹	1/2"FNPT	76.2	44.5	14.3	15000 (1034)
SS-20U-16/12-20S/F	1"20中压锥面螺纹	3/4"FNPT	76.2	44.5	14.3	10000 (690)
SS-20U-16/12-20S/F	1"20中压锥面螺纹	1"FNPT	76.2	44.5	14.3	10000 (690)

A

20中压锥面螺纹-G阴螺纹

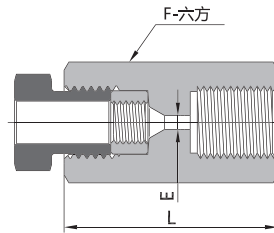

型号	端口1	端口2	尺寸, mm			工作压力 psi (bar)
			L	F	E	
SS-20U-4/2-20S/FG	1/4"20中压锥面螺纹	1/8"G阴螺纹	34.3	15.9	2.8	20000 (1380)
SS-20U-4/4-20S/FG	1/4"20中压锥面螺纹	1/4"G阴螺纹	39.2	23.8	2.8	20000 (1380)
SS-20U-4/6-20S/FG	1/4"20中压锥面螺纹	3/8"G阴螺纹	40.5	28.6	2.8	20000 (1380)
SS-20U-4/8-20S/FG	1/4"20中压锥面螺纹	1/2"G阴螺纹	49.8	34.9	2.8	20000 (1380)
SS-20U-6/2-20S/FG	3/8"20中压锥面螺纹	1/8"G阴螺纹	37.5	19.1	5.2	20000 (1380)
SS-20U-6/4-20S/FG	3/8"20中压锥面螺纹	1/4"G阴螺纹	42.4	23.8	5.2	20000 (1380)
SS-20U-6/6-20S/FG	3/8"20中压锥面螺纹	3/8"G阴螺纹	45	28.6	5.2	20000 (1380)
SS-20U-6/8-20S/FG	3/8"20中压锥面螺纹	1/2"G阴螺纹	53	34.9	5.2	20000 (1380)
SS-20U-6/12-20S/FG	3/8"20中压锥面螺纹	3/4"G阴螺纹	55.4	38.1	5.2	15000 (1034)
SS-20U-9/2-20S/FG	9/16"20中压锥面螺纹	1/8"G阴螺纹	40.7	25.4	7.9	20000 (1380)
SS-20U-9/4-20S/FG	9/16"20中压锥面螺纹	1/4"G阴螺纹	48.7	25.4	7.9	20000 (1380)
SS-20U-9/6-20S/FG	9/16"20中压锥面螺纹	3/8"G阴螺纹	50	28.6	7.9	20000 (1380)
SS-20U-9/8-20S/FG	9/16"20中压锥面螺纹	1/2"G阴螺纹	56.2	34.9	7.9	20000 (1380)
SS-20U-9/12-20S/FG	9/16"20中压锥面螺纹	3/4"G阴螺纹	55.4	38.1	7.9	15000 (1034)
SS-20U-9/16-20S/FG	9/16"20中压锥面螺纹	1"G阴螺纹	63.8	44.5	7.9	15000 (1034)
SS-20U-12/8-20S/FG	3/4"20中压锥面螺纹	1/8"G阴螺纹	43.9	34.9	8.1	20000 (1380)
SS-20U-12/4-20S/FG	3/4"20中压锥面螺纹	1/4"G阴螺纹	48.7	34.9	10.4	20000 (1380)
SS-20U-12/6-20S/FG	3/4"20中压锥面螺纹	3/8"G阴螺纹	59.5	34.9	11.1	20000 (1380)
SS-20U-12/8-20S/FG	3/4"20中压锥面螺纹	1/2"G阴螺纹	65.7	34.9	11.1	20000 (1380)
SS-20U-12/12-20S/FG	3/4"20中压锥面螺纹	3/4"G阴螺纹	64.9	38.1	11.1	15000 (1034)
SS-20U-12/16-20S/FG	3/4"20中压锥面螺纹	1"G阴螺纹	63.8	44.5	11.1	15000 (1034)
SS-20U-16/4-20S/FG	1"20中压锥面螺纹	1/4"G阴螺纹	58.2	44.5	10.4	20000 (1380)
SS-20U-16/6-20S/FG	1"20中压锥面螺纹	3/8"G阴螺纹	62.7	44.5	13.9	20000 (1380)
SS-20U-16/8-20S/FG	1"20中压锥面螺纹	1/2"G阴螺纹	75.2	44.5	14.3	20000 (1380)
SS-20U-16/12-20S/FG	1"20中压锥面螺纹	3/4"G阴螺纹	74.4	44.5	14.3	15000 (1034)
SS-20U-16/16-20S/FG	1"20中压锥面螺纹	1"G阴螺纹	73.3	44.5	14.3	15000 (1034)

A

60高压锥面螺纹-G阴螺纹

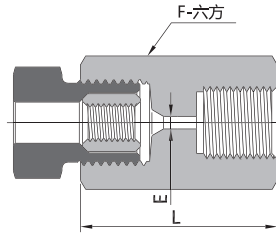

型号	端口1	端口2	尺寸, mm			工作压力 psi (bar)
			L	F	E	
SS-60U-4/2-60S/FG	1/4"60高压锥面螺纹	1/8"G阴螺纹	34.3	19.1	2.4	30000 (2069)
SS-60U-4/4-60S/FG	1/4"60高压锥面螺纹	1/4"G阴螺纹	39.2	23.8	2.4	30000 (2069)
SS-60U-4/6-60S/FG	1/4"60高压锥面螺纹	3/8"G阴螺纹	41	28.6	2.4	30000 (2069)
SS-60U-4/8-60S/FG	1/4"60高压锥面螺纹	1/2"G阴螺纹	49.8	34.9	2.4	30000 (2069)
SS-60U-4/12-60S/FG	1/4"60高压锥面螺纹	3/4"G阴螺纹	49.0	38.1	2.4	15000 (1034)
SS-60U-4/16-60S/FG	1/4"60高压锥面螺纹	1"G阴螺纹	57.4	44.5	2.4	15000 (1034)
SS-60U-6/2-60S/FG	3/8"60高压锥面螺纹	1/8"G阴螺纹	41	25.4	3.2	30000 (2069)
SS-60U-6/4-60S/FG	3/8"60高压锥面螺纹	1/4"G阴螺纹	45.5	25.4	3.2	30000 (2069)
SS-60U-6/6-60S/FG	3/8"60高压锥面螺纹	3/8"G阴螺纹	46.8	28.6	3.2	30000 (2069)
SS-60U-6/8-60S/FG	3/8"60高压锥面螺纹	1/2"G阴螺纹	53.0	34.9	3.2	30000 (2069)
SS-60U-6/12-60S/FG	3/8"60高压锥面螺纹	3/4"G阴螺纹	52	38.1	3.2	15000 (1034)
SS-60U-6/16-60S/FG	3/8"60高压锥面螺纹	1"G阴螺纹	54.3	44.5	3.2	15000 (1034)
SS-60U-9/2-60S/FG	9/16"60高压锥面螺纹	1/8"G阴螺纹	45.0	34.9	4.8	30000 (2069)
SS-60U-9/4-60S/FG	9/16"60高压锥面螺纹	1/4"G阴螺纹	48.7	34.9	4.8	30000 (2069)
SS-60U-9/6-60S/FG	9/16"60高压锥面螺纹	3/8"G阴螺纹	50.0	34.9	4.8	30000 (2069)
SS-60U-9/8-60S/FG	9/16"60高压锥面螺纹	1/2"G阴螺纹	59.3	34.9	4.8	30000 (2069)
SS-60U-9/12-60S/FG	9/16"60高压锥面螺纹	3/4"G阴螺纹	58.5	38.1	4.8	15000 (1034)
SS-60U-9/16-60S/FG	9/16"60高压锥面螺纹	1"G阴螺纹	60.6	44.5	4.8	15000 (1034)

A

60高压锥面螺纹-NPT阳螺纹

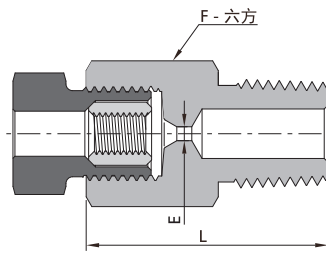

型号	端口1	端口2	尺寸, mm			工作压力 psi (bar)
			L	F	E	
SS-60U-4/2-60S/M	1/4"60高压锥面螺纹	1/8"MNPT	31.8	19.1	2.4	15000 (1034)
SS-60U-4/4-60S/M	1/4"60高压锥面螺纹	1/4"MNPT	34.9	19.1	2.4	15000 (1034)
SS-60U-4/6-60S/M	1/4"60高压锥面螺纹	3/8"MNPT	34.9	19.1	2.4	15000 (1034)
SS-60U-4/8-60S/M	1/4"60高压锥面螺纹	1/2"MNPT	38.1	22.2	2.4	15000 (1034)
SS-60U-4/12-60S/M	1/4"60高压锥面螺纹	3/4"MNPT	44.5	27	2.4	10000 (690)
SS-60U-6/2-60S/M	3/8"60高压锥面螺纹	1/8"MNPT	38.1	25.4	3.2	15000 (1034)
SS-60U-6/4-60S/M	3/8"60高压锥面螺纹	1/4"MNPT	41.3	25.4	3.2	15000 (1034)
SS-60U-6/6-60S/M	3/8"60高压锥面螺纹	3/8"MNPT	41.3	25.4	3.2	15000 (1034)
SS-60U-6/8-60S/M	3/8"60高压锥面螺纹	1/2"MNPT	44.5	25.4	3.2	15000 (1034)
SS-60U-6/12-60S/M	3/8"60高压锥面螺纹	3/4"MNPT	50.8	27	3.2	10000 (690)
SS-60U-6/16-60S/M	3/8"60高压锥面螺纹	1"MNPT	50.8	34.9	3.2	10000 (690)
SS-60U-9/2-60S/M	9/16"60高压锥面螺纹	1/8"MNPT	41.3	34.9	4.8	15000 (1034)
SS-60U-9/4-60S/M	9/16"60高压锥面螺纹	1/4"MNPT	44.5	34.9	4.8	15000 (1034)
SS-60U-9/6-60S/M	9/16"60高压锥面螺纹	3/8"MNPT	44.5	34.9	4.8	15000 (1034)
SS-60U-9/8-60S/M	9/16"60高压锥面螺纹	1/2"MNPT	47.6	34.9	4.8	15000 (1034)
SS-60U-9/12-60S/M	9/16"60高压锥面螺纹	3/4"MNPT	54	34.9	4.8	10000 (690)
SS-60U-9/16-60S/M	9/16"60高压锥面螺纹	1"MNPT	57.2	34.9	4.8	10000 (690)

A

20中压锥面螺纹-NPT阳螺纹

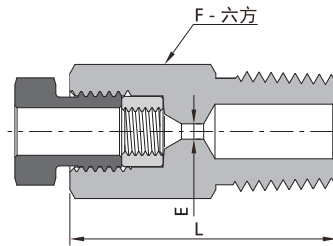

型号	端口1	端口2	尺寸, mm			工作压力 psi (bar)
			L	F	E	
SS-20U-4/2-20S/M	1/4"20中压锥面螺纹	1/8"MNPT	30.2	15.9	2.8	15000 (1034)
SS-20U-4/4-20S/M	1/4"20中压锥面螺纹	1/4"MNPT	34.9	15.9	2.8	15000 (1034)
SS-20U-4/6-20S/M	1/4"20中压锥面螺纹	3/8"MNPT	34.9	17.5	2.8	15000 (1034)
SS-20U-4/8-20S/M	1/4"20中压锥面螺纹	1/2"MNPT	34.9	22.2	2.8	15000 (1034)
SS-20U-4/12-20S/M	1/4"20中压锥面螺纹	3/4"MNPT	44.5	27	2.8	10000 (690)
SS-20U-6/2-20S/M	3/8"20中压锥面螺纹	1/8"MNPT	34.9	19.1	4.8	15000 (1034)
SS-20U-6/4-20S/M	3/8"20中压锥面螺纹	1/4"MNPT	38.1	19.1	5.2	15000 (1034)
SS-20U-6/6-20S/M	3/8"20中压锥面螺纹	3/8"MNPT	38.1	19.1	5.2	15000 (1034)
SS-20U-6/8-20S/M	3/8"20中压锥面螺纹	1/2"MNPT	41.3	22.2	5.2	15000 (1034)
SS-20U-6/12-20S/M	3/8"20中压锥面螺纹	3/4"MNPT	44.5	27	5.2	10000 (690)
SS-20U-6/16-20S/M	3/8"20中压锥面螺纹	1"MNPT	50.8	34.9	5.2	10000 (690)
SS-20U-9/2-20S/M	9/16"20中压锥面螺纹	1/8"MNPT	44.5	25.4	4.8	15000 (1034)
SS-20U-9/4-20S/M	9/16"20中压锥面螺纹	1/4"MNPT	44.5	25.4	6.4	15000 (1034)
SS-20U-9/6-20S/M	9/16"20中压锥面螺纹	3/8"MNPT	44.5	25.4	7.9	15000 (1034)
SS-20U-9/8-20S/M	9/16"20中压锥面螺纹	1/2"MNPT	49.2	25.4	7.9	15000 (1034)
SS-20U-9/12-20S/M	9/16"20中压锥面螺纹	3/4"MNPT	50.8	27	7.9	10000 (690)
SS-20U-9/16-20S/M	9/16"20中压锥面螺纹	1"MNPT	57.2	34.9	7.9	10000 (690)
SS-20U-12/4-20S/M	3/4"20中压锥面螺纹	1/4"MNPT	50.8	34.9	6.4	15000 (1034)
SS-20U-12/6-20S/M	3/4"20中压锥面螺纹	3/8"MNPT	50.8	34.9	7.9	15000 (1034)
SS-20U-12/8-20S/M	3/4"20中压锥面螺纹	1/2"MNPT	55.6	34.9	9.6	15000 (1034)
SS-20U-12/12-20S/M	3/4"20中压锥面螺纹	3/4"MNPT	57.2	34.9	11.1	10000 (690)
SS-20U-12/16-20S/M	3/4"20中压锥面螺纹	1"MNPT	66.7	34.9	11.1	10000 (690)
SS-20U-16/4-20S/M	1"20中压锥面螺纹	1/4"MNPT	73	44.5	6.4	15000 (1034)
SS-20U-16/6-20S/M	1"20中压锥面螺纹	3/8"MNPT	73	44.5	7.9	15000 (1034)
SS-20U-16/8-20S/M	1"20中压锥面螺纹	1/2"MNPT	73	44.5	9.6	15000 (1034)
SS-20U-16/12-20S/M	1"20中压锥面螺纹	3/4"MNPT	73	44.5	14.3	10000 (690)
SS-20U-16/12-20S/M	1"20中压锥面螺纹	1"MNPT	77.8	44.5	14.3	10000 (690)

A

20中压锥面螺纹-60°内锥阳螺纹

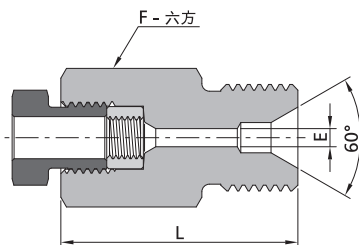

型号	端口1	端口2	尺寸, mm			工作压力 psi (bar)
			L	F	E	
SS-20U-4/9-20S/TM	1/4"20中压锥面螺纹	9/16"60°内锥阳螺纹	30.2	15.9	2.4	20000 (1379)
SS-20U-4/12-20S/TM	1/4"20中压锥面螺纹	3/4"60°内锥阳螺纹	33.3	19.1	2.8	20000 (1379)
SS-20U-4/14-20S/TM	1/4"20中压锥面螺纹	7/8"60°内锥阳螺纹	38.1	25.4	2.8	20000 (1379)
SS-20U-6/9-20S/TM	3/8"20中压锥面螺纹	9/16"60°内锥阳螺纹	34.9	19.1	2.4	20000 (1379)
SS-20U-6/12-20S/TM	3/8"20中压锥面螺纹	3/4"60°内锥阳螺纹	38.1	19.1	2.4	20000 (1379)
SS-20U-6/14-20S/TM	3/8"20中压锥面螺纹	7/8"60°内锥阳螺纹	41.3	25.4	3.8	20000 (1379)
SS-20U-6/16-20S/TM	3/8"20中压锥面螺纹	1"60°内锥阳螺纹	41.3	25.4	5.2	20000 (1379)
SS-20U-9/9-20S/TM	9/16"20中压锥面螺纹	9/16"60°内锥阳螺纹	42.9	25.4	2.4	20000 (1379)
SS-20U-9/12-20S/TM	9/16"20中压锥面螺纹	3/4"60°内锥阳螺纹	46	25.4	7.4	20000 (1379)
SS-20U-9/14-20S/TM	9/16"20中压锥面螺纹	7/8"60°内锥阳螺纹	49.2	25.4	3.8	20000 (1379)
SS-20U-9/16-20S/TM	9/16"20中压锥面螺纹	1"60°内锥阳螺纹	46	25.4	7.9	20000 (1379)
SS-20U-9/21-20S/TM	9/16"20中压锥面螺纹	1 5/16"60°内锥阳螺纹	46	34.9	7.9	20000 (1379)
SS-20U-12/14-20S/TM	3/4"20中压锥面螺纹	7/8"60°内锥阳螺纹	55.6	34.9	3.8	20000 (1379)
SS-20U-12/16-20S/TM	3/4"20中压锥面螺纹	1"60°内锥阳螺纹	54	34.9	10	20000 (1379)
SS-20U-12/21-20S/TM	3/4"20中压锥面螺纹	1 5/16"60°内锥阳螺纹	50.8	34.9	11.1	20000 (1379)
SS-20U-16/21-20S/TM	1"20中压锥面螺纹	1 5/16"60°内锥阳螺纹	65.1	44.5	14.3	20000 (1379)

60高压锥螺纹-60°内锥阳螺纹

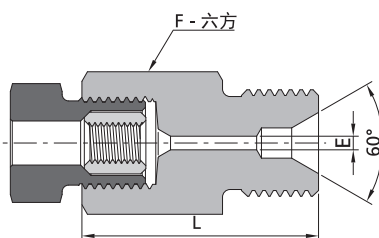

型号	端口1	端口2	尺寸, mm			工作压力 psi (bar)
			L	F	E	
SS-60U-4/9-60S/TM	1/4"60高压锥面螺纹	9/16"60°内锥阳螺纹	31.8	19.1	2.4	60000 (4137)
SS-60U-4/12-60S/TM	1/4"60高压锥面螺纹	3/4"60°内锥阳螺纹	35	19.1	2.4	30000 (2068)
SS-60U-4/14-60S/TM	1/4"60高压锥面螺纹	7/8"60°内锥阳螺纹	39.7	25.4	2.4	50000 (3447)
SS-60U-4/16-60S/TM	1/4"60高压锥面螺纹	1"60°内锥阳螺纹	34.9	25.4	2.4	30000 (2068)
SS-60U-6/9-60S/TM	3/8"60高压锥面螺纹	9/16"60°内锥阳螺纹	38.1	25.4	2.4	60000 (4137)
SS-60U-6/12-60S/TM	3/8"60高压锥面螺纹	3/4"60°内锥阳螺纹	41.3	25.4	3.2	30000 (2068)
SS-60U-6/14-60S/TM	3/8"60高压锥面螺纹	7/8"60°内锥阳螺纹	46	25.4	3.2	50000 (3447)
SS-60U-6/16-60S/TM	3/8"60高压锥面螺纹	1"60°内锥阳螺纹	41.6	25.4	3.2	30000 (2068)
SS-60U-6/21-60S/TM	3/8"60高压锥面螺纹	1 5/16"60°内锥阳螺纹	39.7	34.9	3.2	20000 (1379)
SS-60U-9/14-60S/TM	9/16"60高压锥面螺纹	7/8"60°内锥阳螺纹	50.8	34.9	3.8	50000 (3447)
SS-60U-9/16-60S/TM	9/16"60高压锥面螺纹	1"60°内锥阳螺纹	46	34.9	4.8	30000 (2068)
SS-60U-9/21-60S/TM	9/16"60高压锥面螺纹	1 5/16"60°内锥阳螺纹	46	34.9	4.8	20000 (1379)

20中压锥面阳螺纹-60°内锥阳螺纹

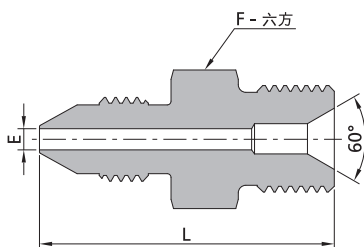

型号	端口1	端口2	尺寸, mm			工作压力 psi (bar)
			L	F	E	
SS-20U-4/9-20M/TM	1/4"20中压锥面阳螺纹	9/16"60°内锥阳螺纹	38.7	15.9	2.4	20000 (1379)
SS-20U-4/12-20M/TM	1/4"20中压锥面阳螺纹	3/4"60°内锥阳螺纹	43	19.1	2.8	20000 (1379)
SS-20U-4/14-20M/TM	1/4"20中压锥面阳螺纹	7/8"60°内锥阳螺纹	48.2	25.4	2.8	20000 (1379)
SS-20U-4/16-20M/TM	1/4"20中压锥面阳螺纹	1"60°内锥阳螺纹	45.3	25.4	2.8	20000 (1379)
SS-20U-4/21-20M/TM	1/4"20中压锥面阳螺纹	1 5/16"60°内锥阳螺纹	48.3	34.9	2.8	20000 (1379)
SS-20U-6/9-20M/TM	3/8"20中压锥面阳螺纹	9/16"60°内锥阳螺纹	42.4	15.9	2.4	20000 (1379)
SS-20U-6/12-20M/TM	3/8"20中压锥面阳螺纹	3/4"60°内锥阳螺纹	46.7	19.1	5.2	20000 (1379)
SS-20U-6/14-20M/TM	3/8"20中压锥面阳螺纹	7/8"60°内锥阳螺纹	51.9	25.4	3.8	20000 (1379)
SS-20U-6/16-20M/TM	3/8"20中压锥面阳螺纹	1"60°内锥阳螺纹	49	25.4	5.2	20000 (1379)
SS-20U-6/21-20M/TM	3/8"20中压锥面阳螺纹	1 5/16"60°内锥阳螺纹	52	34.9	5.2	20000 (1379)
SS-20U-9/9-20M/TM	9/16"20中压锥面阳螺纹	9/16"60°内锥阳螺纹	49.6	23.8	2.4	20000 (1379)
SS-20U-9/12-20M/TM	9/16"20中压锥面阳螺纹	3/4"60°内锥阳螺纹	52.9	23.8	7.4	20000 (1379)
SS-20U-9/14-20M/TM	9/16"20中压锥面阳螺纹	7/8"60°内锥阳螺纹	56.7	25.4	3.8	20000 (1379)
SS-20U-9/16-20M/TM	9/16"20中压锥面阳螺纹	1"60°内锥阳螺纹	53.8	25.4	7.9	20000 (1379)
SS-20U-9/21-20M/TM	9/16"20中压锥面阳螺纹	1 5/16"60°内锥阳螺纹	56.8	34.9	7.9	20000 (1379)
SS-20U-12/9-20M/TM	3/4"20中压锥面阳螺纹	9/16"60°内锥阳螺纹	56.3	30.2	2.4	20000 (1379)
SS-20U-12/12-20M/TM	3/4"20中压锥面阳螺纹	3/4"60°内锥阳螺纹	59.6	30.2	7.4	20000 (1379)
SS-20U-12/14-20M/TM	3/4"20中压锥面阳螺纹	7/8"60°内锥阳螺纹	62.8	30.2	3.8	20000 (1379)
SS-20U-12/16-20M/TM	3/4"20中压锥面阳螺纹	1"60°内锥阳螺纹	59.9	30.2	10	20000 (1379)
SS-20U-12/21-20M/TM	3/4"20中压锥面阳螺纹	1 5/16"60°内锥阳螺纹	61.1	34.9	11.1	20000 (1379)
SS-20U-16/9-20M/TM	1"20中压锥面阳螺纹	9/16"60°内锥阳螺纹	70.3	38.1	2.4	20000 (1379)
SS-20U-16/12-20M/TM	1"20中压锥面阳螺纹	3/4"60°内锥阳螺纹	73.6	38.1	7.4	20000 (1379)
SS-20U-16/14-20M/TM	1"20中压锥面阳螺纹	7/8"60°内锥阳螺纹	76.8	38.1	3.8	20000 (1379)
SS-20U-16/16-20M/TM	1"20中压锥面阳螺纹	1"60°内锥阳螺纹	73.9	38.1	10	20000 (1379)
SS-20U-16/21-20M/TM	1"20中压锥面阳螺纹	1 5/16"60°内锥阳螺纹	73.3	38.1	14.3	20000 (1379)

A

60°高压锥面阳螺纹-60°内锥阳螺纹

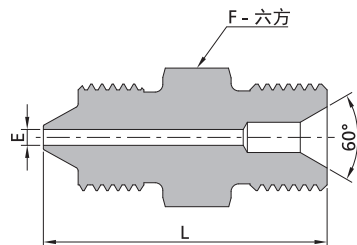

型号	端口1	端口2	尺寸, mm			工作压力 psi (bar)
			L	F	E	
SS-60U-4/9-60M/TM	1/4"60°高压锥面阳螺纹	9/16"60°内锥阳螺纹	37.1	15.9	2.1	60000 (4137)
SS-60U-4/12-60M/TM	1/4"60°高压锥面阳螺纹	3/4"60°内锥阳螺纹	41.4	19.1	2.1	30000 (2068)
SS-60U-4/14-60M/TM	1/4"60°高压锥面阳螺纹	7/8"60°内锥阳螺纹	46.6	25.4	2.1	50000 (3447)
SS-60U-4/16-60M/TM	1/4"60°高压锥面阳螺纹	1"60°内锥阳螺纹	43.7	25.4	2.1	30000 (2068)
SS-60U-4/21-60M/TM	1/4"60°高压锥面阳螺纹	1 5/16"60°内锥阳螺纹	46.7	34.9	2.1	20000 (1379)
SS-60U-6/9-60M/TM	3/8"60°高压锥面阳螺纹	9/16"60°内锥阳螺纹	44.9	20.6	2.4	60000 (4137)
SS-60U-6/12-60M/TM	3/8"60°高压锥面阳螺纹	3/4"60°内锥阳螺纹	48.2	20.6	3.2	30000 (2068)
SS-60U-6/14-60M/TM	3/8"60°高压锥面阳螺纹	7/8"60°内锥阳螺纹	53	25.4	3.2	50000 (3447)
SS-60U-6/16-60M/TM	3/8"60°高压锥面阳螺纹	1"60°内锥阳螺纹	50.1	25.4	3.2	30000 (2068)
SS-60U-6/21-60M/TM	3/8"60°高压锥面阳螺纹	1 5/16"60°内锥阳螺纹	53.1	34.9	3.2	20000 (1379)
SS-60U-9/9-60M/TM	9/16"60°高压锥面阳螺纹	9/16"60°内锥阳螺纹	52.6	30.2	2.4	60000 (4137)
SS-60U-9/12-60M/TM	9/16"60°高压锥面阳螺纹	3/4"60°内锥阳螺纹	55.9	30.2	4.8	30000 (2068)
SS-60U-9/14-60M/TM	9/16"60°高压锥面阳螺纹	7/8"60°内锥阳螺纹	59.1	30.2	3.8	50000 (3447)
SS-60U-9/16-60M/TM	9/16"60°高压锥面阳螺纹	1"60°内锥阳螺纹	56.2	30.2	4.8	30000 (2068)
SS-60U-9/21-60M/TM	9/16"60°高压锥面阳螺纹	1 5/16"60°内锥阳螺纹	57.4	34.9	4.8	20000 (1379)

NPT阴螺纹-60°高压螺纹管

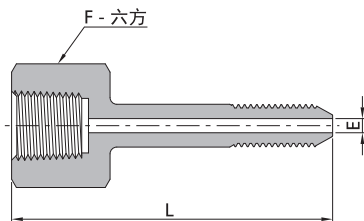

型号	端口1	端口2	尺寸, mm			工作压力 psi (bar)
			L	F	E	
SS-20U-2/4-F/T20	1/8"FNPT	1/4"20中压螺纹管	47.6	15.9	2.1	15000 (1034)
SS-20U-2/6-F/T20	1/8"FNPT	3/8"20中压螺纹管	55.6	15.9	3.2	15000 (1034)
SS-20U-4/4-F/T20	1/4"FNPT	1/4"20中压螺纹管	54	23.8	2.1	15000 (1034)
SS-20U-4/6-F/T20	1/4"FNPT	3/8"20中压螺纹管	63.5	23.8	3.2	15000 (1034)
SS-20U-4/9-F/T20	1/4"FNPT	9/16"20中压螺纹管	77.8	23.8	4.8	15000 (1034)
SS-20U-6/4-F/T20	3/8"FNPT	1/4"20中压螺纹管	54	28.6	2.1	15000 (1034)
SS-20U-6/6-F/T20	3/8"FNPT	3/8"20中压螺纹管	63.5	28.6	3.2	15000 (1034)
SS-20U-6/9-F/T20	3/8"FNPT	9/16"20中压螺纹管	79.4	28.6	4.8	15000 (1034)
SS-20U-8/4-F/T20	1/2"FNPT	1/4"20中压螺纹管	60.3	34.9	2.1	15000 (1034)
SS-20U-8/6-F/T20	1/2"FNPT	3/8"20中压螺纹管	69.9	34.9	3.2	15000 (1034)
SS-20U-8/9-F/T20	1/2"FNPT	9/16"20中压螺纹管	84.2	34.9	4.8	15000 (1034)
SS-20U-12/4-F/T20	3/4"FNPT	1/4"20中压螺纹管	61.9	38.1	2.1	10000 (690)
SS-20U-12/6-F/T20	3/4"FNPT	3/8"20中压螺纹管	71.4	38.1	3.2	10000 (690)
SS-20U-12/9-F/T20	3/4"FNPT	9/16"20中压螺纹管	85.8	38.1	4.8	10000 (690)
SS-20U-16/4-F/T20	1"FNPT	1/4"20中压螺纹管	68.3	44.5	2.1	10000 (690)
SS-20U-16/6-F/T20	1"FNPT	3/8"20中压螺纹管	78.8	44.5	3.2	10000 (690)
SS-20U-16/9-F/T20	1"FNPT	9/16"20中压螺纹管	93.8	44.5	4.8	10000 (690)

NPT阴螺纹-20中压螺纹管

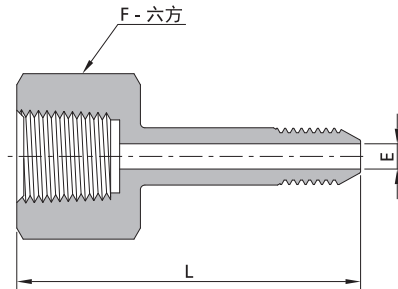

型号	端口1	端口2	尺寸, mm			工作压力 psi (bar)
			L	F	E	
SS-20U-2/4-F/20M	1/8"FNPT	1/4"20中压阳螺纹	38.1	15.9	2.8	15000 (1034)
SS-20U-2/6-F/20M	1/8"FNPT	3/8"20中压阳螺纹	44.5	15.9	5.2	15000 (1034)
SS-20U-2/9-F/20M	1/8"FNPT	9/16"20中压阳螺纹	49.2	15.9	7.9	15000 (1034)
SS-20U-2/12-F/20M	1/8"FNPT	3/4"20中压阳螺纹	54	22.2	7.9	15000 (1034)
SS-20U-2/16-F/20M	1/8"FNPT	1"20中压阳螺纹	71.4	28.6	7.9	15000 (1034)
SS-20U-4/4-F/20M	1/4"FNPT	1/4"20中压阳螺纹	44.5	23.8	2.8	15000 (1034)
SS-20U-4/6-F/20M	1/4"FNPT	3/8"20中压阳螺纹	50.8	23.8	5.2	15000 (1034)
SS-20U-4/9-F/20M	1/4"FNPT	9/16"20中压阳螺纹	55.6	23.8	7.9	15000 (1034)
SS-20U-4/12-F/20M	1/4"FNPT	3/4"20中压阳螺纹	61.9	23.8	10.4	15000 (1034)
SS-20U-4/16-F/20M	1/4"FNPT	1"20中压阳螺纹	74.6	28.6	10.4	15000 (1034)
SS-20U-6/6-F/20M	3/8"FNPT	3/8"20中压阳螺纹	52.4	28.6	5.2	15000 (1034)
SS-20U-6/9-F/20M	3/8"FNPT	9/16"20中压阳螺纹	57.2	28.6	7.9	15000 (1034)
SS-20U-6/12-F/20M	3/8"FNPT	3/4"20中压阳螺纹	63.5	28.6	11.1	15000 (1034)
SS-20U-6/16-F/20M	3/8"FNPT	1"20中压阳螺纹	76.2	28.6	14.3	15000 (1034)
SS-20U-8/9-F/20M	1/2"FNPT	9/16"20中压阳螺纹	63.5	34.9	7.9	15000 (1034)
SS-20U-8/12-F/20M	1/2"FNPT	3/4"20中压阳螺纹	69.9	34.9	11.1	15000 (1034)
SS-20U-8/16-F/20M	1/2"FNPT	1"20中压阳螺纹	82.6	34.9	14.3	15000 (1034)
SS-20U-12/9-F/20M	3/4"FNPT	9/16"20中压阳螺纹	65.1	38.1	7.9	10000 (690)
SS-20U-12/12-F/20M	3/4"FNPT	3/4"20中压阳螺纹	71.4	38.1	11.1	10000 (690)
SS-20U-12/16-F/20M	3/4"FNPT	1"20中压阳螺纹	86	38.1	14.3	10000 (690)
SS-20U-16/12-F/20M	1"FNPT	3/4"20中压阳螺纹	79.4	44.5	11.1	10000 (690)
SS-20U-16/16-F/20M	1"FNPT	1"20中压阳螺纹	92.2	44.5	14.3	10000 (690)

60高压锥面阳螺纹-60高压锥面阳螺纹

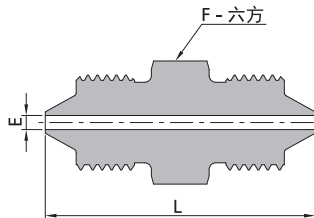

型号	端口1	端口2	尺寸, mm			工作压力 psi (bar)
			L	F	E	
SS-60U-4-60M	1/4"60高压锥面阳螺纹	1/4"60高压锥面阳螺纹	41.3	15.9	2.1	60000 (4137)
SS-60U-6/4-60M/60M	3/8"60高压锥面阳螺纹	1/4"60高压锥面阳螺纹	49.2	20.6	2.1	60000 (4137)
SS-60U-6-60M	3/8"60高压锥面阳螺纹	3/8"60高压锥面阳螺纹	55.6	20.6	3.2	60000 (4137)
SS-60U-9/4-60M/60M	9/16"60高压锥面阳螺纹	1/4"60高压锥面阳螺纹	55.6	30.2	2.1	60000 (4137)
SS-60U-9/6-60M/60M	9/16"60高压锥面阳螺纹	3/8"60高压锥面阳螺纹	63.5	30.2	3.2	60000 (4137)
SS-60U-9-60M	9/16"60高压锥面阳螺纹	9/16"60高压锥面阳螺纹	66.7	30.2	4.8	60000 (4137)

20中压锥面阳螺纹-20中压锥面阳螺纹

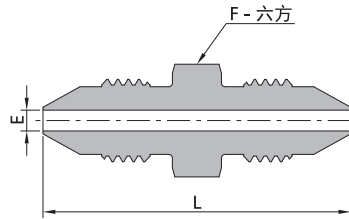

型号	端口1	端口2	尺寸, mm			工作压力 bar(PSI)
			L	F	E	
SS-20U-4-20M	1/4"20中压锥面阳螺纹	1/4"20中压锥面阳螺纹	41.3	12.7	2.8	20000 (1379)
SS-20U-6/4-20M/20M	3/8"20中压锥面阳螺纹	1/4"20中压锥面阳螺纹	47.6	15.9	2.8	20000 (1379)
SS-20U-6-20M	3/8"20中压锥面阳螺纹	3/8"20中压锥面阳螺纹	50.8	15.9	5.2	20000 (1379)
SS-20U-9/4-20M/20M	9/16"20中压锥面阳螺纹	1/4"20中压锥面阳螺纹	54	23.8	2.8	20000 (1379)
SS-20U-9/6-20M/20M	9/16"20中压锥面阳螺纹	3/8"20中压锥面阳螺纹	58.7	23.8	5.2	20000 (1379)
SS-20U-9-20M	9/16"20中压锥面阳螺纹	9/16"20中压锥面阳螺纹	63.5	23.8	7.9	20000 (1379)
SS-20U-12/4-20M/20M	3/4"20中压锥面阳螺纹	1/4"20中压锥面阳螺纹	61.9	30.2	2.8	20000 (1379)
SS-20U-12/6-20M/20M	3/4"20中压锥面阳螺纹	3/8"20中压锥面阳螺纹	65.1	30.2	5.2	20000 (1379)
SS-20U-12/9-20M/20M	3/4"20中压锥面阳螺纹	9/16"20中压锥面阳螺纹	69.9	30.2	7.9	20000 (1379)
SS-20U-12-20M	3/4"20中压锥面阳螺纹	3/4"20中压锥面阳螺纹	74.6	30.2	11.1	20000 (1379)
SS-20U-16/4-20M/20M	1"20中压锥面阳螺纹	1/4"20中压锥面阳螺纹	76.2	38.1	2.8	20000 (1379)
SS-20U-16/6-20M/20M	1"20中压锥面阳螺纹	3/8"20中压锥面阳螺纹	79.4	38.1	5.2	20000 (1379)
SS-20U-16/9-20M/20M	1"20中压锥面阳螺纹	9/16"20中压锥面阳螺纹	84.2	38.1	7.9	20000 (1379)
SS-20U-16/12-20M/20M	1"20中压锥面阳螺纹	3/4"20中压锥面阳螺纹	87.4	38.1	11.1	20000 (1379)
SS-20U-16-20M	1"20中压锥面阳螺纹	1"20中压锥面阳螺纹	100.2	38.1	14.3	20000 (1379)

60高压锥面阳螺纹-20中压锥面阳螺纹

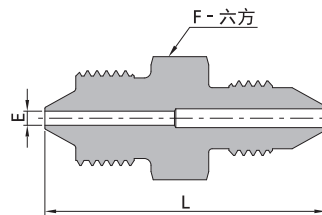

型号	端口1	端口2	尺寸, mm			工作压力 psi (bar)
			L	F	E	
SS-60U-4/4-60M/20M	1/4"60高压锥面阳螺纹	1/4"20中压锥面阳螺纹	42.9	15.9	2.1	20000 (1379)
SS-60U-4/6-60M/20M	1/4"60高压锥面阳螺纹	3/8"20中压锥面阳螺纹	46	15.9	2.1	20000 (1379)
SS-60U-4/9-60M/20M	1/4"60高压锥面阳螺纹	9/16"20中压锥面阳螺纹	52.4	23.8	2.1	20000 (1379)
SS-60U-4/12-60M/20M	1/4"60高压锥面阳螺纹	3/4"20中压锥面阳螺纹	60.3	30.2	2.1	20000 (1379)
SS-60U-4/16-60M/20M	1/4"60高压锥面阳螺纹	1"20中压锥面阳螺纹	74.6	38.1	2.1	20000 (1379)
SS-60U-6/4-60M/20M	3/8"60高压锥面阳螺纹	1/4"20中压锥面阳螺纹	50.8	20.6	2.8	20000 (1379)
SS-60U-6/6-60M/20M	3/8"60高压锥面阳螺纹	3/8"20中压锥面阳螺纹	54	20.6	3.2	20000 (1379)
SS-60U-6/9-60M/20M	3/8"60高压锥面阳螺纹	9/16"20中压锥面阳螺纹	60.3	23.8	3.2	20000 (1379)
SS-60U-6/12-60M/20M	3/8"60高压锥面阳螺纹	3/4"20中压锥面阳螺纹	66.7	30.2	3.2	20000 (1379)
SS-60U-6/16-60M/20M	3/8"60高压锥面阳螺纹	1"20中压锥面阳螺纹	79.4	38.1	3.2	20000 (1379)
SS-60U-9/4-60M/20M	9/16"60高压锥面阳螺纹	1/4"20中压锥面阳螺纹	57.2	30.2	2.8	20000 (1379)
SS-60U-9/6-60M/20M	9/16"60高压锥面阳螺纹	3/8"20中压锥面阳螺纹	61.9	30.2	4.8	20000 (1379)
SS-60U-9/9-60M/20M	9/16"60高压锥面阳螺纹	9/16"20中压锥面阳螺纹	66.7	30.2	4.8	20000 (1379)
SS-60U-9/12-60M/20M	9/16"60高压锥面阳螺纹	3/4"20中压锥面阳螺纹	71	30.2	4.8	20000 (1379)
SS-60U-9/16-60M/20M	9/16"60高压锥面阳螺纹	1"20中压锥面阳螺纹	84.2	38.1	4.8	20000 (1379)

20中压锥面阳螺纹-NPT阳螺纹

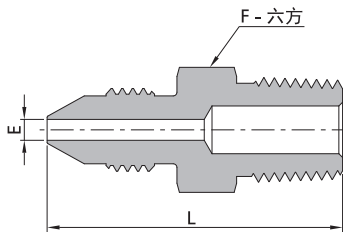

型号	端口1	端口2	尺寸, mm			工作压力 psi (bar)
			L	F	E	
SS-20U-4/2-20M/M	1/4"20中压锥面阳螺纹	1/8"MNPT	34.9	12.7	2.8	15000 (1034)
SS-20U-4/4-20M/M	1/4"20中压锥面阳螺纹	1/4"MNPT	39.7	14.3	2.8	15000 (1034)
SS-20U-4/-20M/M	1/4"20中压锥面阳螺纹	3/8"MNPT	41.3	17.5	2.8	15000 (1034)
SS-20U-4/-20M/M	1/4"20中压锥面阳螺纹	1/2"MNPT	47.6	22.2	2.8	15000 (1034)
SS-20U-4/12-20M/M	1/4"20中压锥面阳螺纹	3/4"MNPT	49.2	27	2.8	10000 (690)
SS-20U-4/16-20M/M	1/4"20中压锥面阳螺纹	1"MNPT	57.2	34.9	2.8	10000 (690)
SS-20U-6/2-20M/M	3/8"20中压锥面阳螺纹	1/8"MNPT	39.7	15.9	4.8	15000 (1034)
SS-20U-6/4-20M/M	3/8"20中压锥面阳螺纹	1/4"MNPT	44.5	15.9	5.2	15000 (1034)
SS-20U-6/-20M/M	3/8"20中压锥面阳螺纹	3/8"MNPT	44.5	17.5	5.2	15000 (1034)
SS-20U-6/-20M/M	3/8"20中压锥面阳螺纹	1/2"MNPT	50.8	22.2	5.2	15000 (1034)
SS-20U-6/12-20M/M	3/8"20中压锥面阳螺纹	3/4"MNPT	52.4	27	5.2	10000 (690)
SS-20U-6/16-20M/M	3/8"20中压锥面阳螺纹	1"MNPT	60.3	34.9	5.2	10000 (690)
SS-20U-9/2-20M/M	9/16"20中压锥面阳螺纹	1/8"MNPT	47.6	23.8	4.8	15000 (1034)
SS-20U-9/4-20M/M	9/16"20中压锥面阳螺纹	1/4"MNPT	52.4	23.8	6.4	15000 (1034)
SS-20U-9/-20M/M	9/16"20中压锥面阳螺纹	3/8"MNPT	52.4	23.8	7.9	15000 (1034)
SS-20U-9/-20M/M	9/16"20中压锥面阳螺纹	1/2"MNPT	57.2	23.8	7.9	15000 (1034)
SS-20U-9/12-20M/M	9/16"20中压锥面阳螺纹	3/4"MNPT	58.7	27	7.9	10000 (690)
SS-20U-9/16-20M/M	9/16"20中压锥面阳螺纹	1"MNPT	65.1	34.9	7.9	10000 (690)
SS-20U-12/2-20M/M	3/4"20中压锥面阳螺纹	1/8"MNPT	54	30.2	4.8	15000 (1034)
SS-20U-12/4-20M/M	3/4"20中压锥面阳螺纹	1/4"MNPT	58.7	30.2	6.4	15000 (1034)
SS-20U-12/-20M/M	3/4"20中压锥面阳螺纹	3/8"MNPT	58.7	30.2	7.9	15000 (1034)
SS-20U-12/-20M/M	3/4"20中压锥面阳螺纹	1/2"MNPT	63.5	30.2	9.6	15000 (1034)
SS-20U-12/12-20M/M	3/4"20中压锥面阳螺纹	3/4"MNPT	63.5	30.2	11.1	10000 (690)
SS-20U-12/16-20M/M	3/4"20中压锥面阳螺纹	1"MNPT	69.9	34.9	11.1	10000 (690)
SS-20U-16/2-20M/M	1"20中压锥面阳螺纹	1/8"MNPT	68.3	38.1	4.8	15000 (1034)
SS-20U-16/4-20M/M	1"20中压锥面阳螺纹	1/4"MNPT	71.4	38.1	6.4	15000 (1034)
SS-20U-16/-20M/M	1"20中压锥面阳螺纹	3/8"MNPT	71.4	38.1	7.9	15000 (1034)
SS-20U-16/-20M/M	1"20中压锥面阳螺纹	1/2"MNPT	77.8	38.1	9.6	15000 (1034)
SS-20U-16/12-20M/M	1"20中压锥面阳螺纹	3/4"MNPT	82.6	38.1	14.3	10000 (690)
SS-20U-16/16-20M/M	1"20中压锥面阳螺纹	1"MNPT	82.6	38.1	14.3	10000 (690)

A

60高压锥面阳螺纹-NPT阳螺纹

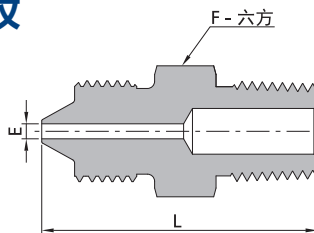

型号	端口1	端口2	尺寸, mm			工作压力 psi (bar)
			L	F	E	
SS-60U-4/2-60M/M	1/4"60高压锥面阳螺纹	1/8"MNPT	34.9	15.9	2.1	15000 (1034)
SS-60U-4/4-60M/M	1/4"60高压锥面阳螺纹	1/4"MNPT	39.7	15.9	2.1	15000 (1034)
SS-60U-4/6-60M/M	1/4"60高压锥面阳螺纹	3/8"MNPT	39.7	17.5	2.1	15000 (1034)
SS-60U-4/8-60M/M	1/4"60高压锥面阳螺纹	1/2"MNPT	46	22.2	2.1	15000 (1034)
SS-60U-4/12-60M/M	1/4"60高压锥面阳螺纹	3/4"MNPT	47.6	27	2.1	10000 (690)
SS-60U-4/16-60M/M	1/4"60高压锥面阳螺纹	1"MNPT	55.6	34.9	2.1	10000 (690)
SS-60U-6/2-60M/M	3/8"60高压锥面阳螺纹	1/8"MNPT	42.9	20.6	3.2	15000 (1034)
SS-60U-6/4-60M/M	3/8"60高压锥面阳螺纹	1/4"MNPT	47.6	20.6	3.2	15000 (1034)
SS-60U-6/6-60M/M	3/8"60高压锥面阳螺纹	3/8"MNPT	47.6	20.6	3.2	15000 (1034)
SS-60U-6/8-60M/M	3/8"60高压锥面阳螺纹	1/2"MNPT	52.4	22.2	3.2	15000 (1034)
SS-60U-6/12-60M/M	3/8"60高压锥面阳螺纹	3/4"MNPT	54	27	3.2	10000 (690)
SS-60U-6/16-60M/M	3/8"60高压锥面阳螺纹	1"MNPT	61.9	34.9	3.2	10000 (690)
SS-60U-9/2-60M/M	9/16"60高压锥面阳螺纹	1/8"MNPT	50.8	30.2	4.8	15000 (1034)
SS-60U-9/4-60M/M	9/16"60高压锥面阳螺纹	1/4"MNPT	54	30.2	4.8	15000 (1034)
SS-60U-9/6-60M/M	9/16"60高压锥面阳螺纹	3/8"MNPT	54	30.2	4.8	15000 (1034)
SS-60U-9/8-60M/M	9/16"60高压锥面阳螺纹	1/2"MNPT	60.3	30.2	4.8	15000 (1034)
SS-60U-9/12-60M/M	9/16"60高压锥面阳螺纹	3/4"MNPT	60.3	30.2	4.8	10000 (690)
SS-60U-9/16-60M/M	9/16"60高压锥面阳螺纹	1"MNPT	66.7	34.9	4.8	10000 (690)

60高压锥面阳螺纹-JIC阳螺纹

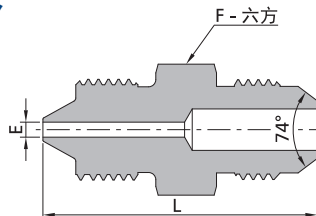

型号	端口1	端口2	尺寸, mm			工作压力 psi (bar)
			L	F	E	
SS-60U-4/4-60M/JM	1/4"60高压锥面阳螺纹	1/4"JIC阳螺纹	38.4	15.9	2.1	20000 (1379)
SS-60U-4/6-60M/JM	1/4"60高压锥面阳螺纹	3/8"JIC阳螺纹	39.7	15.9	2.1	20000 (1379)
SS-60U-4/8-60M/JM	1/4"60高压锥面阳螺纹	1/2"JIC阳螺纹	42.9	20.6	2.1	20000 (1379)
SS-60U-4/10-60M/JM	1/4"60高压锥面阳螺纹	5/8"JIC阳螺纹	46	23.8	2.1	20000 (1379)
SS-60U-4/12-60M/JM	1/4"60高压锥面阳螺纹	3/4"JIC阳螺纹	50.8	28.6	2.1	15000 (1034)
SS-60U-4/16-60M/JM	1/4"60高压锥面阳螺纹	1"JIC阳螺纹	54	34.9	2.1	15000 (1034)
SS-60U-6/4-60M/JM	3/8"60高压锥面阳螺纹	1/4"JIC阳螺纹	46	20.6	3.2	20000 (1379)
SS-60U-6/6-60M/JM	3/8"60高压锥面阳螺纹	3/8"JIC阳螺纹	46	20.6	3.2	20000 (1379)
SS-60U-6/8-60M/JM	3/8"60高压锥面阳螺纹	1/2"JIC阳螺纹	49.2	20.6	3.2	20000 (1379)
SS-60U-6/10-60M/JM	3/8"60高压锥面阳螺纹	5/8"JIC阳螺纹	52.4	23.8	3.2	20000 (1379)
SS-60U-6/12-60M/JM	3/8"60高压锥面阳螺纹	3/4"JIC阳螺纹	57.2	28.6	3.2	15000 (1034)
SS-60U-6/16-60M/JM	3/8"60高压锥面阳螺纹	1"JIC阳螺纹	60.3	34.9	3.2	15000 (1034)
SS-60U-9/4-60M/JM	9/16"60高压锥面阳螺纹	1/4"JIC阳螺纹	54	30.2	4.4	20000 (1379)
SS-60U-9/6-60M/JM	9/16"60高压锥面阳螺纹	3/8"JIC阳螺纹	54	30.2	4.8	20000 (1379)
SS-60U-9/8-60M/JM	9/16"60高压锥面阳螺纹	1/2"JIC阳螺纹	57.2	30.2	4.8	20000 (1379)
SS-60U-9/5-60M/JM	9/16"60高压锥面阳螺纹	5/8"JIC阳螺纹	60.3	30.2	4.8	20000 (1379)
SS-60U-9/12-60M/JM	9/16"60高压锥面阳螺纹	3/4"JIC阳螺纹	61.9	30.2	4.8	15000 (1034)
SS-60U-9/16-60M/JM	9/16"60高压锥面阳螺纹	1"JIC阳螺纹	65	34.9	4.8	15000 (1034)

20中压锥面阳螺纹-JIC阳螺纹

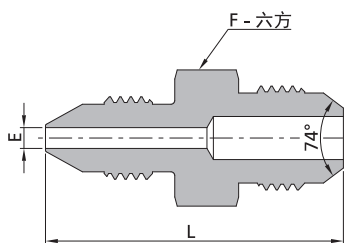

型号	端口1	端口2	尺寸, mm			工作压力 bar (psi)
			L	F	E	
SS-20U-4/4-20M/JM	1/4"20中压锥面阳螺纹	1/4"JIC阳螺纹	38.1	12.7	2.8	20000 (1379)
SS-20U-4/-20M/JM	1/4"20中压锥面阳螺纹	3/8"JIC阳螺纹	41.3	15.9	2.8	20000 (1379)
SS-20U-4/-20M/JM	1/4"20中压锥面阳螺纹	1/2"JIC阳螺纹	44.5	20.6	2.8	20000 (1379)
SS-20U-4/5-20M/JM	1/4"20中压锥面阳螺纹	5/8"JIC阳螺纹	47.6	23.8	2.8	20000 (1379)
SS-20U-4/12-20M/JM	1/4"20中压锥面阳螺纹	3/4"JIC阳螺纹	52.4	28.6	2.8	15000 (1034)
SS-20U-4/16-20M/JM	1/4"20中压锥面阳螺纹	1"JIC阳螺纹	55.6	34.9	2.8	15000 (1034)
SS-20U-6/4-20M/JM	3/8"20中压锥面阳螺纹	1/4"JIC阳螺纹	44.5	15.9	4.4	20000 (1379)
SS-20U-6/-20M/JM	3/8"20中压锥面阳螺纹	3/8"JIC阳螺纹	44.5	15.9	5.2	20000 (1379)
SS-20U-6/-20M/JM	3/8"20中压锥面阳螺纹	1/2"JIC阳螺纹	47.6	20.6	5.2	20000 (1379)
SS-20U-6/5-20M/JM	3/8"20中压锥面阳螺纹	5/8"JIC阳螺纹	52.4	23.8	5.2	20000 (1379)
SS-20U-6/12-20M/JM	3/8"20中压锥面阳螺纹	3/4"JIC阳螺纹	57.2	28.6	5.2	15000 (1034)
SS-20U-6/16-20M/JM	3/8"20中压锥面阳螺纹	1"JIC阳螺纹	60.3	34.9	5.2	15000 (1034)
SS-20U-9/4-20M/JM	9/16"20中压锥面阳螺纹	1/4"JIC阳螺纹	50.8	23.8	4.4	20000 (1379)
SS-20U-9/-20M/JM	9/16"20中压锥面阳螺纹	3/8"JIC阳螺纹	51	23.8	5.8	20000 (1379)
SS-20U-9/-20M/JM	9/16"20中压锥面阳螺纹	1/2"JIC阳螺纹	54	23.8	7.9	20000 (1379)
SS-20U-9/5-20M/JM	9/16"20中压锥面阳螺纹	5/8"JIC阳螺纹	57.2	23.8	7.9	20000 (1379)
SS-20U-9/12-20M/JM	9/16"20中压锥面阳螺纹	3/4"JIC阳螺纹	61.9	28.6	7.9	15000 (1034)
SS-20U-9/16-20M/JM	9/16"20中压锥面阳螺纹	1"JIC阳螺纹	65.1	34.9	7.9	15000 (1034)
SS-20U-12/4-20M/JM	3/4"20中压锥面阳螺纹	1/4"JIC阳螺纹	58.7	30.2	4.4	20000 (1379)
SS-20U-12/-20M/JM	3/4"20中压锥面阳螺纹	3/8"JIC阳螺纹	58.7	30.2	5.8	20000 (1379)
SS-20U-12/-20M/JM	3/4"20中压锥面阳螺纹	1/2"JIC阳螺纹	60.3	30.2	7.9	20000 (1379)
SS-20U-12/5-20M/JM	3/4"20中压锥面阳螺纹	5/8"JIC阳螺纹	63.5	30.2	9.4	20000 (1379)
SS-20U-12/12-20M/JM	3/4"20中压锥面阳螺纹	3/4"JIC阳螺纹	66.7	30.2	11.1	15000 (1034)
SS-20U-12/16-20M/JM	3/4"20中压锥面阳螺纹	1"JIC阳螺纹	68.3	34.9	11.1	15000 (1034)
SS-20U-16/4-20M/JM	1"20中压锥面阳螺纹	1/4"JIC阳螺纹	71.4	38.1	4.4	20000 (1379)
SS-20U-16/-20M/JM	1"20中压锥面阳螺纹	3/8"JIC阳螺纹	71.4	38.1	5.8	20000 (1379)
SS-20U-16/-20M/JM	1"20中压锥面阳螺纹	1/2"JIC阳螺纹	74.6	38.1	7.9	20000 (1379)
SS-20U-16/5-20M/JM	1"20中压锥面阳螺纹	5/8"JIC阳螺纹	77.8	38.1	9.4	20000 (1379)
SS-20U-16/12-20M/JM	1"20中压锥面阳螺纹	3/4"JIC阳螺纹	79.4	38.1	11.6	15000 (1034)
SS-20U-16/16-20M/JM	1"20中压锥面阳螺纹	1"JIC阳螺纹	81	38.1	14.3	15000 (1034)

A

20中压锥面阳螺纹-NPT阴螺纹

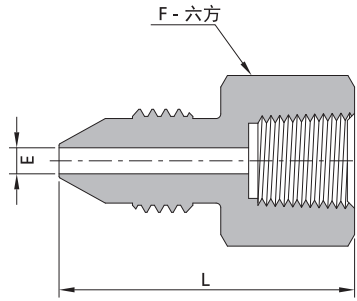

型号	端口1	端口2	尺寸, mm			工作压力 psi (bar)
			L	F	E	
SS-20U-4/2-20M/F	1/4"20中压锥面阳螺纹	1/8"FNPT	31.8	15.9	2.8	15000 (1034)
SS-20U-6/2-20M/F	3/8"20中压锥面阳螺纹	1/8"FNPT	34.9	15.9	5.2	15000 (1034)
SS-20U-9/2-20M/F	9/16"20中压锥面阳螺纹	1/8"FNPT	38.1	23.8	7.9	15000 (1034)
SS-20U-12/2-20M/F	3/4"20中压锥面阳螺纹	1/8"FNPT	44.5	30.2	7.9	15000 (1034)
SS-20U-16/2-20M/F	1"20中压锥面阳螺纹	1/8"FNPT	60.3	38.1	7.9	15000 (1034)
SS-20U-4/4-20M/F	1/4"20中压锥面阳螺纹	1/4"FNPT	38	23.8	2.8	15000 (1034)
SS-20U-6/4-20M/F	3/8"20中压锥面阳螺纹	1/4"FNPT	41.3	23.8	5.2	15000 (1034)
SS-20U-9/4-20M/F	9/16"20中压锥面阳螺纹	1/4"FNPT	44.5	23.8	7.9	15000 (1034)
SS-20U-12/4-20M/F	3/4"20中压锥面阳螺纹	1/4"FNPT	47.6	30.2	10.4	15000 (1034)
SS-20U-16/4-20M/F	1"20中压锥面阳螺纹	1/4"FNPT	60.3	38.1	10.4	15000 (1034)
SS-20U-4/6-20M/F	1/4"20中压锥面阳螺纹	3/8"FNPT	38.1	28.6	2.8	15000 (1034)
SS-20U-6/6-20M/F	3/8"20中压锥面阳螺纹	3/8"FNPT	42.9	28.6	5.2	15000 (1034)
SS-20U-9/6-20M/F	9/16"20中压锥面阳螺纹	3/8"FNPT	46	28.6	7.9	15000 (1034)
SS-20U-12/6-20M/F	3/4"20中压锥面阳螺纹	3/8"FNPT	50.8	30.2	11.1	15000 (1034)
SS-20U-16/6-20M/F	1"20中压锥面阳螺纹	3/8"FNPT	60.3	38.1	14.3	15000 (1034)
SS-20U-4/8-20M/F	1/4"20中压锥面阳螺纹	1/2"FNPT	44.5	34.9	2.8	15000 (1034)
SS-20U-6/8-20M/F	3/8"20中压锥面阳螺纹	1/2"FNPT	47.6	34.9	5.2	15000 (1034)
SS-20U-9/8-20M/F	9/16"20中压锥面阳螺纹	1/2"FNPT	52.4	34.9	7.9	15000 (1034)
SS-20U-12/8-20M/F	3/4"20中压锥面阳螺纹	1/2"FNPT	55.6	34.9	11.1	15000 (1034)
SS-20U-16/8-20M/F	1"20中压锥面阳螺纹	1/2"FNPT	65.1	38.1	14.3	15000 (1034)
SS-20U-4/12-20M/F	1/4"20中压锥面阳螺纹	3/4"FNPT	46	38.1	2.8	10000 (690)
SS-20U-6/12-20M/F	3/8"20中压锥面阳螺纹	3/4"FNPT	49.2	38.1	5.2	10000 (690)
SS-20U-9/12-20M/F	9/16"20中压锥面阳螺纹	3/4"FNPT	54	38.1	7.9	10000 (690)
SS-20U-12/12-20M/F	3/4"20中压锥面阳螺纹	3/4"FNPT	58.7	38.1	11.1	10000 (690)
SS-20U-16/12-20M/F	1"20中压锥面阳螺纹	3/4"FNPT	69.9	38.1	14.3	10000 (690)
SS-20U-4/16-20M/F	1/4"20中压锥面阳螺纹	1"FNPT	52.4	44.5	2.8	10000 (690)
SS-20U-6/16-20M/F	3/8"20中压锥面阳螺纹	1"FNPT	55.6	44.5	5.2	10000 (690)
SS-20U-9/16-20M/F	9/16"20中压锥面阳螺纹	1"FNPT	61.9	44.5	7.9	10000 (690)
SS-20U-12/16-20M/F	3/4"20中压锥面阳螺纹	1"FNPT	63.5	44.5	11.1	10000 (690)
SS-20U-16/16-20M/F	1"20中压锥面阳螺纹	1"FNPT	77.8	44.5	14.3	10000 (690)

60高压锥面阳螺纹-NPT阴螺纹

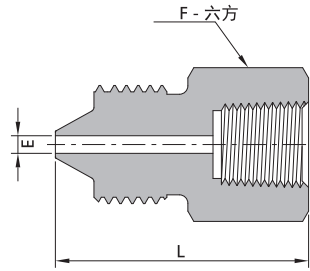

型号	端口1	端口2	尺寸, mm			工作压力 psi (bar)
			L	F	E	
SS-60U-4/2-60M/F	1/4"60高压锥面阳螺纹	1/8"FNPT	30.2	15.9	2.1	15000 (1034)
SS-60U-6/2-60M/F	3/8"60高压锥面阳螺纹	1/8"FNPT	34.9	20.6	3.2	15000 (1034)
SS-60U-9/2-60M/F	9/16"60高压锥面阳螺纹	1/8"FNPT	41.3	30.2	4.8	15000 (1034)
SS-60U-4/4-60M/F	1/4"60高压锥面阳螺纹	1/4"FNPT	34.9	23.8	2.1	15000 (1034)
SS-60U-6/4-60M/F	3/8"60高压锥面阳螺纹	1/4"FNPT	41.3	23.8	3.2	15000 (1034)
SS-60U-9/4-60M/F	9/16"60高压锥面阳螺纹	1/4"FNPT	44.5	30.2	4.8	15000 (1034)
SS-60U-4/6-60M/F	1/4"60高压锥面阳螺纹	3/8"FNPT	36.5	28.6	2.1	15000 (1034)
SS-60U-6/6-60M/F	3/8"60高压锥面阳螺纹	3/8"FNPT	42.9	28.6	3.2	15000 (1034)
SS-60U-9/6-60M/F	9/16"60高压锥面阳螺纹	3/8"FNPT	46	30.2	4.8	15000 (1034)
SS-60U-4/8-60M/F	1/4"60高压锥面阳螺纹	1/2"FNPT	42.9	34.9	2.1	15000 (1034)
SS-60U-6/8-60M/F	3/8"60高压锥面阳螺纹	1/2"FNPT	49.2	34.9	3.2	15000 (1034)
SS-60U-9/8-60M/F	9/16"60高压锥面阳螺纹	1/2"FNPT	54	34.9	4.8	15000 (1034)
SS-60U-4/12-60M/F	1/4"60高压锥面阳螺纹	3/4"FNPT	44.5	38.1	2.1	10000 (690)
SS-60U-6/12-60M/F	3/8"60高压锥面阳螺纹	3/4"FNPT	50.8	38.1	3.2	10000 (690)
SS-60U-9/12-60M/F	9/16"60高压锥面阳螺纹	3/4"FNPT	55.6	38.1	4.8	10000 (690)
SS-60U-4/16-60M/F	1/4"60高压锥面阳螺纹	1"FNPT	50.8	44.5	2.1	10000 (690)
SS-60U-6/16-60M/F	3/8"60高压锥面阳螺纹	1"FNPT	57.2	44.5	3.2	10000 (690)
SS-60U-9/16-60M/F	9/16"60高压锥面阳螺纹	1"FNPT	61.9	44.5	4.8	10000 (690)

A

20中压锥面阳螺纹-G阴螺纹

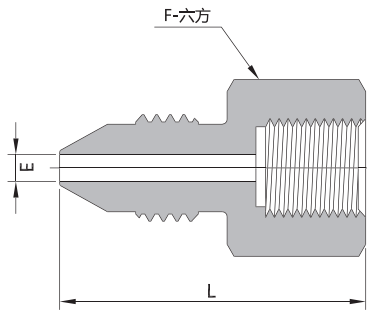

型号	端口1	端口2	尺寸, mm			工作压力 psi (bar)
			L	F	E	
SS-20U-4/2-20M/FG	1/4"20中压锥面阳螺纹	1/8"G阴螺纹	31.2	15.9	2.8	20000 (1380)
SS-20U-6/2-20M/FG	3/8"20中压锥面阳螺纹	1/8"G阴螺纹	34.3	15.9	5.2	20000 (1380)
SS-20U-9/2-20M/FG	9/16"20中压锥面阳螺纹	1/8"G阴螺纹	37.5	23.8	7.9	20000 (1380)
SS-20U-12/2-20M/FG	3/4"20中压锥面阳螺纹	1/8"G阴螺纹	43.9	30.2	7.9	20000 (1380)
SS-20U-16/2-20M/FG	1"20中压锥面阳螺纹	1/8"G阴螺纹	59.7	38.1	7.9	20000 (1380)
SS-20U-4/4-20M/FG	1/4"20中压锥面阳螺纹	1/4"G阴螺纹	36	23.8	2.8	20000 (1380)
SS-20U-6/4-20M/FG	3/8"20中压锥面阳螺纹	1/4"G阴螺纹	39.2	23.8	5.2	20000 (1380)
SS-20U-9/4-20M/FG	9/16"20中压锥面阳螺纹	1/4"G阴螺纹	42.4	23.8	7.9	20000 (1380)
SS-20U-12/4-20M/FG	3/4"20中压锥面阳螺纹	1/4"G阴螺纹	45.5	30.2	10.4	20000 (1380)
SS-20U-16/4-20M/FG	1"20中压锥面阳螺纹	1/4"G阴螺纹	59.5	38.1	10.4	20000 (1380)
SS-20U-4/6-20M/FG	1/4"20中压锥面阳螺纹	3/8"G阴螺纹	37.3	28.6	2.8	20000 (1380)
SS-20U-6/-20M/FG	3/8"20中压锥面阳螺纹	3/8"G阴螺纹	42.1	28.6	5.2	20000 (1380)
SS-20U-9/-20M/FG	9/16"20中压锥面阳螺纹	3/8"G阴螺纹	45	28.6	7.9	20000 (1380)
SS-20U-12/-20M/FG	3/4"20中压锥面阳螺纹	3/8"G阴螺纹	50	30.2	11.1	20000 (1380)
SS-20U-16/-20M/FG	1"20中压锥面阳螺纹	3/8"G阴螺纹	59.5	38.1	14.3	20000 (1380)
SS-20U-4/8-20M/FG	1/4"20中压锥面阳螺纹	1/2"G阴螺纹	43.5	34.9	2.8	20000 (1380)
SS-20U-6/-20M/FG	3/8"20中压锥面阳螺纹	1/2"G阴螺纹	46.6	34.9	5.2	20000 (1380)
SS-20U-9/-20M/FG	9/16"20中压锥面阳螺纹	1/2"G阴螺纹	51.4	34.9	7.9	20000 (1380)
SS-20U-12/-20M/FG	3/4"20中压锥面阳螺纹	1/2"G阴螺纹	54.6	34.9	11.1	20000 (1380)
SS-20U-16/-20M/FG	1"20中压锥面阳螺纹	1/2"G阴螺纹	64.1	38.1	14.3	20000 (1380)
SS-20U-4/12-20M/FG	1/4"20中压锥面阳螺纹	3/4"G阴螺纹	44	38.1	2.8	10000 (690)
SS-20U-6/12-20M/FG	3/8"20中压锥面阳螺纹	3/4"G阴螺纹	47.4	38.1	5.2	10000 (690)
SS-20U-9/12-20M/FG	9/16"20中压锥面阳螺纹	3/4"G阴螺纹	52	38.1	7.9	10000 (690)
SS-20U-12/12-20M/FG	3/4"20中压锥面阳螺纹	3/4"G阴螺纹	56.9	38.1	11.1	10000 (690)
SS-20U-16/12-20M/FG	1"20中压锥面阳螺纹	3/4"G阴螺纹	68.1	38.1	14.3	10000 (690)
SS-20U-4/16-20M/FG	1/4"20中压锥面阳螺纹	1"G阴螺纹	49.5	44.5	2.8	10000 (690)
SS-20U-6/16-20M/FG	3/8"20中压锥面阳螺纹	1"G阴螺纹	52.7	44.5	5.2	10000 (690)
SS-20U-9/16-20M/FG	9/16"20中压锥面阳螺纹	1"G阴螺纹	59	44.5	7.9	10000 (690)
SS-20U-12/16-20M/FG	3/4"20中压锥面阳螺纹	1"G阴螺纹	60.6	44.5	11.1	10000 (690)
SS-20U-16/16-20M/FG	1"20中压锥面阳螺纹	1"G阴螺纹	74.9	44.5	14.3	10000 (690)

60高压锥面阳螺纹-G阴螺纹

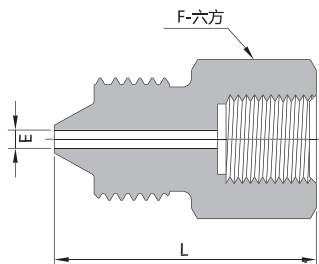

型号	端口1	端口2	尺寸, mm			工作压力 psi (bar)
			L	F	E	
SS-60U-4/2-60M/FG	1/4"60高压锥面阳螺纹	1/8"G阴螺纹	29.6	15.9	2.1	30000 (2069)
SS-60U-6/2-60M/FG	3/8"60高压锥面阳螺纹	1/8"G阴螺纹	34.3	20.6	3.2	30000 (2069)
SS-60U-9/2-60M/FG	9/16"60高压锥面阳螺纹	1/8"G阴螺纹	40.7	30.2	4.8	30000 (2069)
SS-60U-4/4-60M/FG	1/4"60高压锥面阳螺纹	1/4"G阴螺纹	32.8	23.8	2.1	30000 (2069)
SS-60U-6/4-60M/FG	3/8"60高压锥面阳螺纹	1/4"G阴螺纹	39.2	23.8	3.2	30000 (2069)
SS-60U-9/4-60M/FG	9/16"60高压锥面阳螺纹	1/4"G阴螺纹	42.4	30.2	4.8	30000 (2069)
SS-60U-4/6-60M/FG	1/4"60高压锥面阳螺纹	3/8"G阴螺纹	35.7	28.6	2.1	30000 (2069)
SS-60U-6/6-60M/FG	3/8"60高压锥面阳螺纹	3/8"G阴螺纹	42.1	28.6	3.2	30000 (2069)
SS-60U-9/6-60M/FG	9/16"60高压锥面阳螺纹	3/8"G阴螺纹	45	30.2	4.8	30000 (2069)
SS-60U-4/8-60M/FG	1/4"60高压锥面阳螺纹	1/2"G阴螺纹	41.9	34.9	2.1	30000 (2069)
SS-60U-6/8-60M/FG	3/8"60高压锥面阳螺纹	1/2"G阴螺纹	48.2	34.9	3.2	30000 (2069)
SS-60U-9/8-60M/FG	9/16"60高压锥面阳螺纹	1/2"G阴螺纹	53	34.9	4.8	30000 (2069)
SS-60U-4/12-60M/FG	1/4"60高压锥面阳螺纹	3/4"G阴螺纹	42.7	38.1	2.1	15000 (1034)
SS-60U-6/12-60M/FG	3/8"60高压锥面阳螺纹	3/4"G阴螺纹	49	38.1	3.2	15000 (1034)
SS-60U-9/12-60M/FG	9/16"60高压锥面阳螺纹	3/4"G阴螺纹	53.8	38.1	4.8	15000 (1034)
SS-60U-4/16-60M/FG	1/4"60高压锥面阳螺纹	1"G阴螺纹	47.9	44.5	2.1	15000 (1034)
SS-60U-6/16-60M/FG	3/8"60高压锥面阳螺纹	1"G阴螺纹	54.3	44.5	3.2	15000 (1034)
SS-60U-9/16-60M/FG	9/16"60高压锥面阳螺纹	1"G阴螺纹	59	44.5	4.8	15000 (1034)

A

选型说明

SS - 60U - 4 / 4 - 60S / 20S

材料		系列	端口1尺寸		端口2尺寸	端口1形式		端口2形式
SS	316SS	20U 60U	2	1/8"	同端口1选择范围一致	60S	60高压锥面螺纹	同端口1选择范围一致
			4	1/4"		20S	20中压锥面螺纹	
			6	3/8"		60M	60高压锥面阳螺纹	
			8	1/2"		20M	20中压锥面阳螺纹	
			9	9/16"或9/16-18		T60	60高压螺纹管	
			10	5/8"		T20	20中压螺纹管	
			12	3/4"或3/4-16		M	NPT 阳螺纹	
			14	7/8-14		F	NPT 阴螺纹	
			16	1"或1-12		FG	G 阴螺纹	
			21	1 5/16-12		JM	JIC 阳螺纹	
					TM	60°内锥阳螺纹		

注：
选型说明仅做参考，不能随意组合，具体型号以最终技术确认为准。